

Installation Instructions



860662724-AMK-002-INSTALL INSTALLATION INSTRUCTION

PT18,AMK, 4461/4471/4438/440X

- 1.0 GENERAL NOTES
 - 1.1 ALL DIMENSIONS ARE IN MM, IMPERIAL DIMENSIONS ARE IN INCHES AND SHOWN IN BRACKETS [X.X]
- 2.0 DESIGN NOTES
- 3.0 MANUFACTURING/SPECIAL REQUIREMENTS
 - 3.1 TIGHTEN HARDWARES, TORQUE VALUE ARE SHOWN BELOW AS REFERENCE,
 - M5: TORQUE 23.0 IN-LB OR 2.6 N-M
 - M6: TORQUE 40.0 IN-LB OR 4.5 N-M (W/ CLIP NUT)
 - M6: TORQUE 46.0 IN-LB OR 5.2 N-M (W/ THREADED CAST AL)
 - M6: TORQUE 75.0 IN-LB OR 8.5 N-M (W/ STEEL NUT)
 - M8: TORQUE 6.6 FT-LB OR 9.0 N-M (W/ THREADED CAST AL)
 - #6-32: TORQUE 9.5 IN-LB OR 1.1 N-M
 - 3.2 CONFIGURATIONS AND QUANTITY OF EQUIPMENTS IN INSTALLATION ARE LISTED ON TABLE.
 - 3.3 EQUIPMENT INSTALLATION INSTRUCTION ON PAGE 3.
 - 3.4 THE KIT IS PURCHASED SEPARATELY FROM THE PT18.
 - 3.5 CONNECT FAN Y-CABLE TO FANS AND ROUTE IN INTERIOR ALONG THE CENTRE SPINE. LEAVE SUFFICIENT SLACK.
 - LOCATE THERMISTORS 0.5 TO 2.0 INCHES BELOW EDGE INDICATED IN THE AIR SO THERMISTOR IS NOT TOUCHING ANYTHING AND DRESS CABLE WITH TIES
 - 3.6 CONNECT POWER SUPPLY INPUT TO 120V AC SOURCE, ROUTE POWER SUPPLY INPUT CABLE FROM POWER TO BOTTOM PLATE THEN SECURE WITH CABLE TIES.

ERICSSON CONFIGURATION	3.2 APPROVED ERICSSON RADIO CONFIGURATIONS						REQUIRED ADDITIONAL AMK FOR CONFIGURATION (PURCHASED SEPARATELY)
	4438	4461	4471	220X OR 440X	6317	AC08	
1	1			1	1		3.4 860664823-AMK-007
2		1		2	1		1
3	1	1			2		1
4		1	1			2	1
5				4		2	

REVISIONS			
REV.	DESCRIPTION	DATE	APPROVED
A	INITIAL RELEASE	ZL1057 22DEC25	WQ1001 50106234AMO

This table show the evolution and history of document from initial to current version.

Further information regarding ANDREW's commitment can be found at <https://www.andrew.com/sustainability/>.
 Visit our website or contact your local ANDREW representative for more information.
 This product is covered by one or more U.S. patents or their foreign equivalents. For patents, see www.adwpat.com

Installation Instructions



ERICSSON EQUIPMENT MOUNTING INSTALLATION

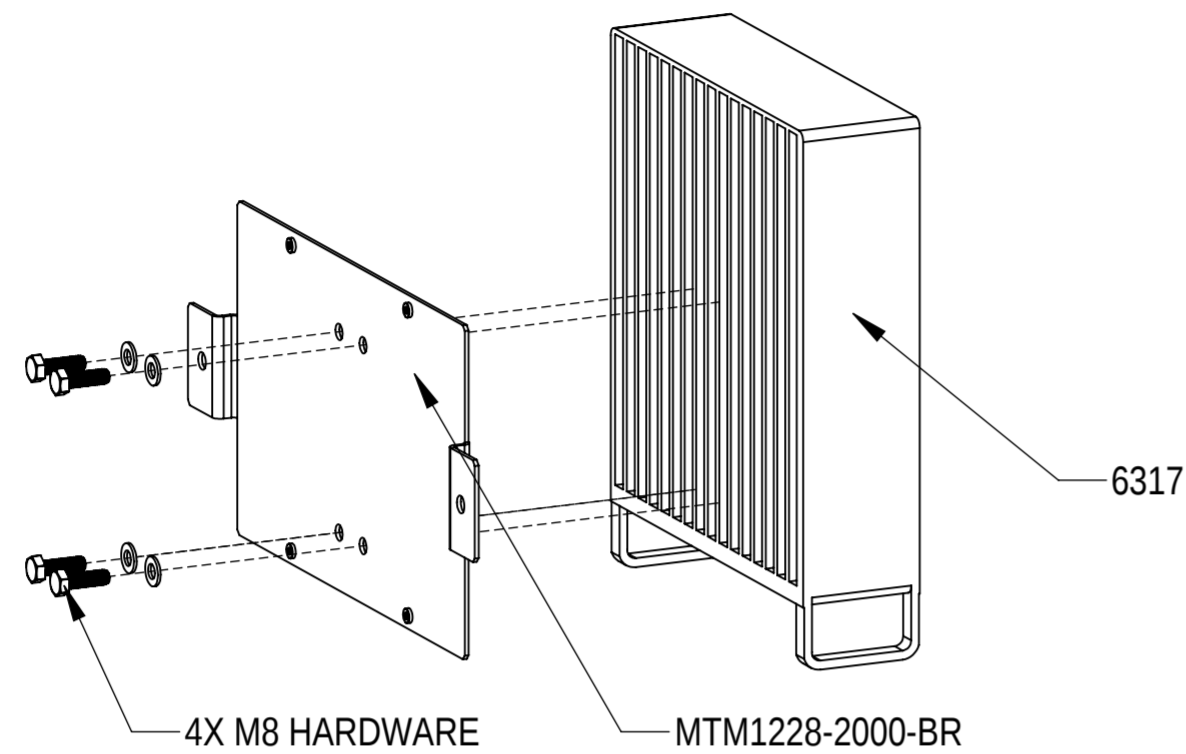

PSU 6317:

INSTALL 6317 TO THE BRACKET MTM1228-2000-BR USING 4 SETS OF M8 SCREWS & FLAT WASHERS AS SHOWN

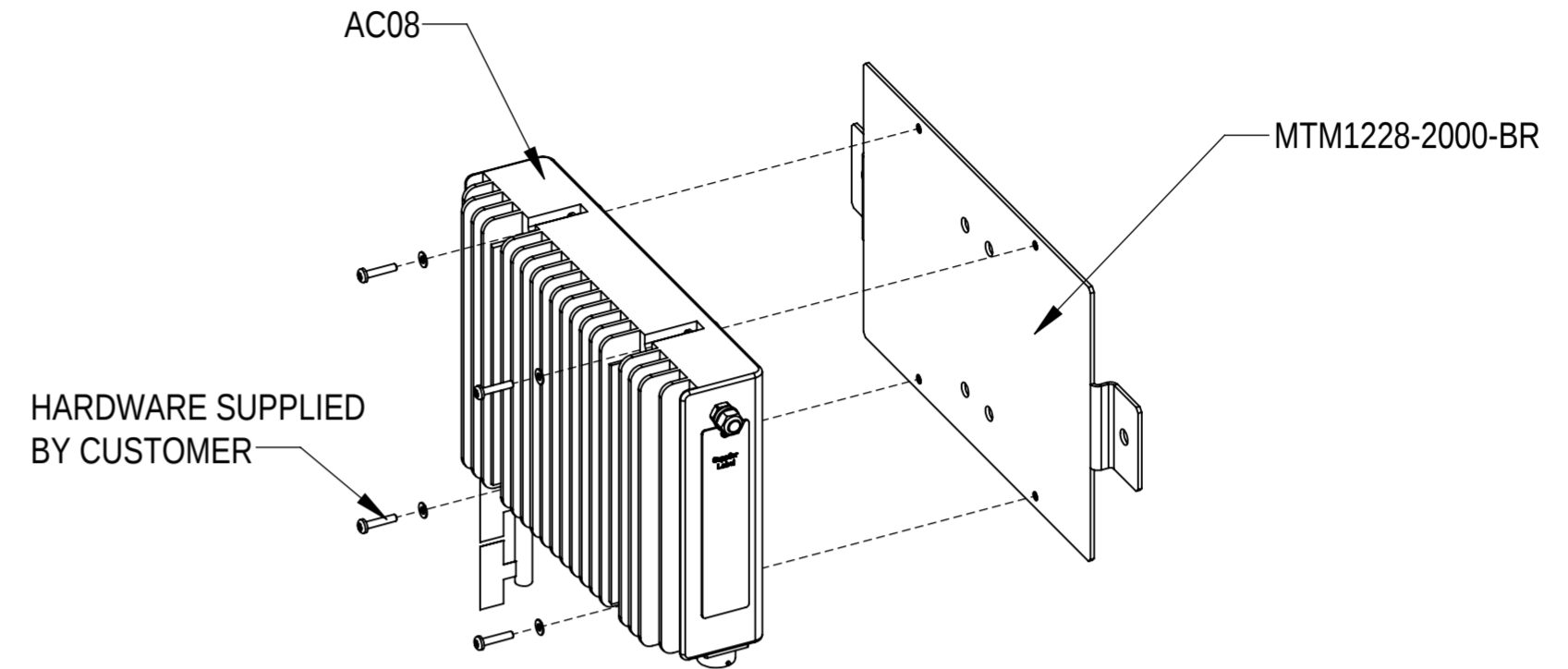

PSU AC08:

INSTALL AC08 TO THE BRACKET MTM1228-2000-BR USING HARDWARE SUPPLIED BY CUSTOMER.

FAN KIT MOUNTING INSTALLATION

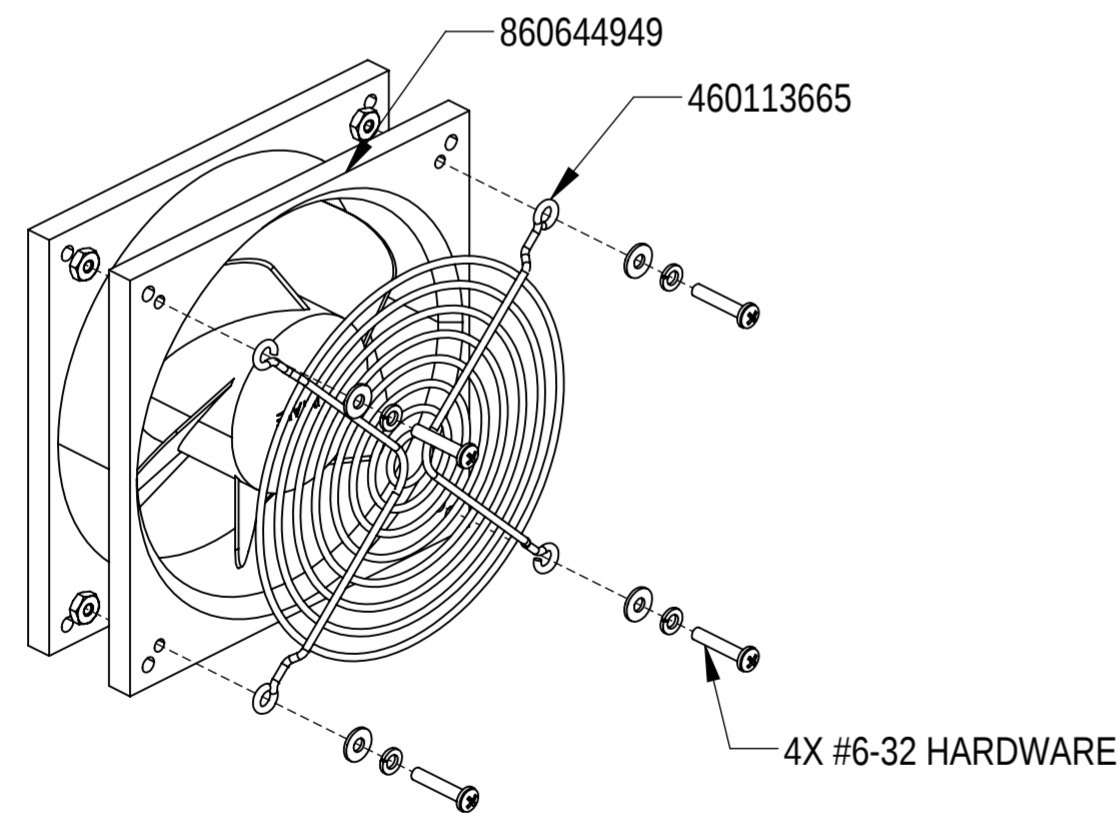

860644949 (SUPPLIED BY 860664823-AMK-007):

1) INSTALL 460113665 TO THE FAN 860644949 USING 4 SETS OF #6-32 SCREWS, M4 LOCK, No 6 FLAT WASHERS AND #6-32 NUTS AS SHOWN

2) INSTALL THE FAN 860644949 TO THE BRACKETS MTM1220-6100-BR & MTM1220-6200-BR USING 4 SETS OF M5 SCREWS, LOCK & FLAT WASHERS AS SHOWN

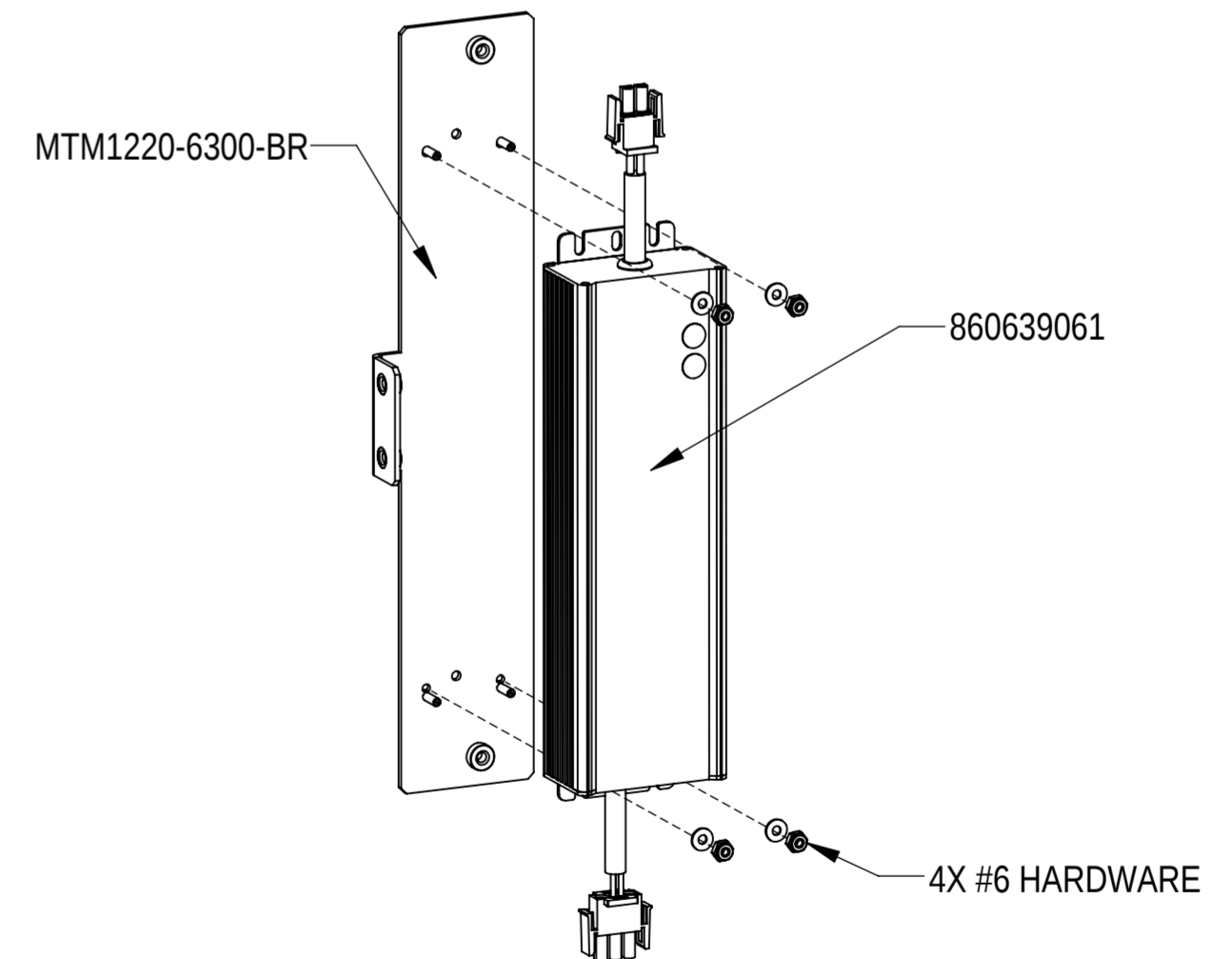
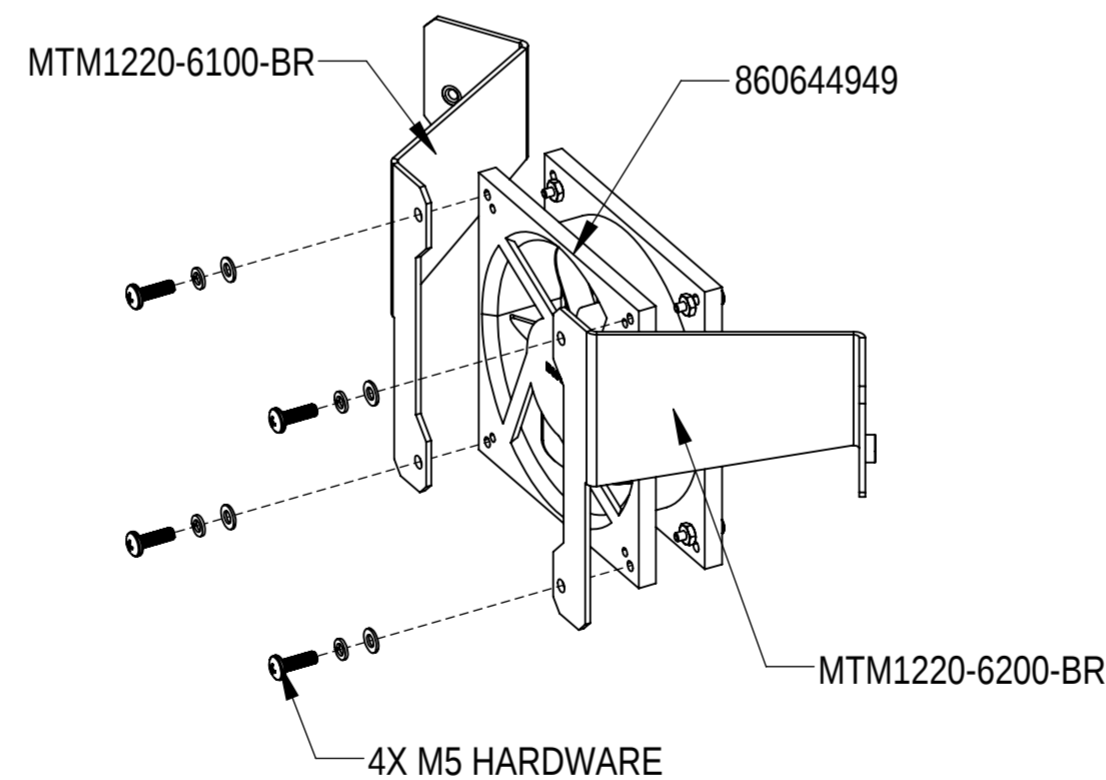

860639061 (SUPPLIED BY 860664823-AMK-007):

INSTALL 860639061 TO THE BRACKET MTM1220-6300-BR USING 4 SETS OF No 6 FLAT WASHERS AND #6-32 NUTS AS SHOWN

Installation Instructions



RADIO INSTALLATION MOUNTING BRACKET MTM1228-1000-BR

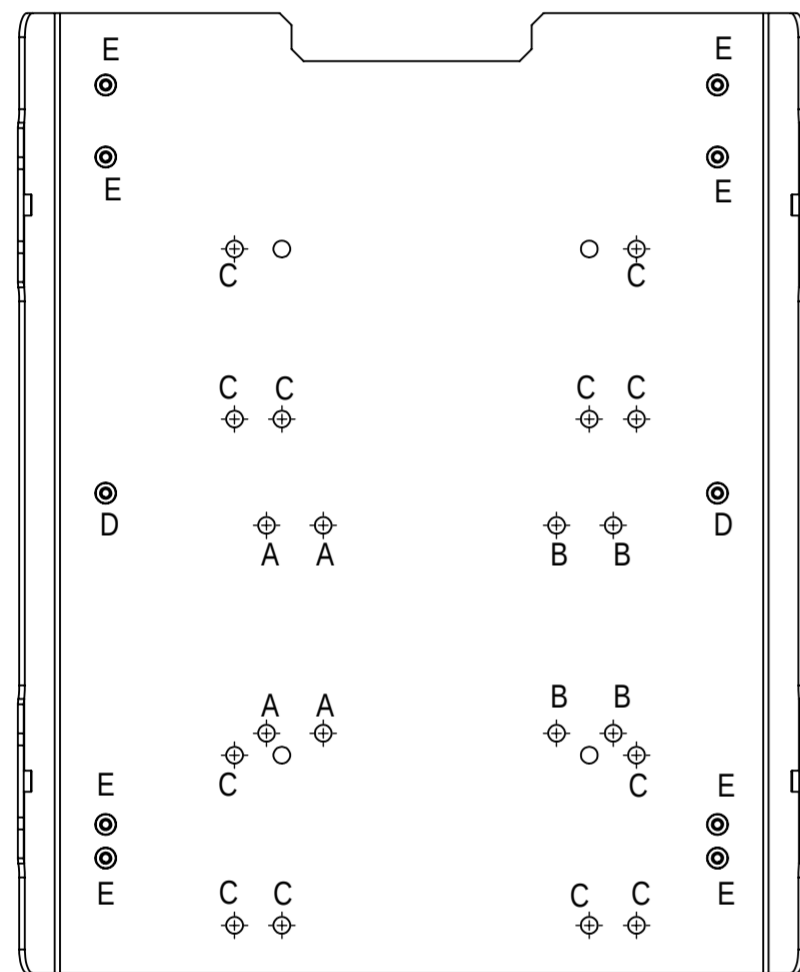

"A": 4438/4471
 "B": 4461
 "C": 220X/440X
 "D": 6317 SUB-ASSY
 "E": AC08 SUB-ASSY

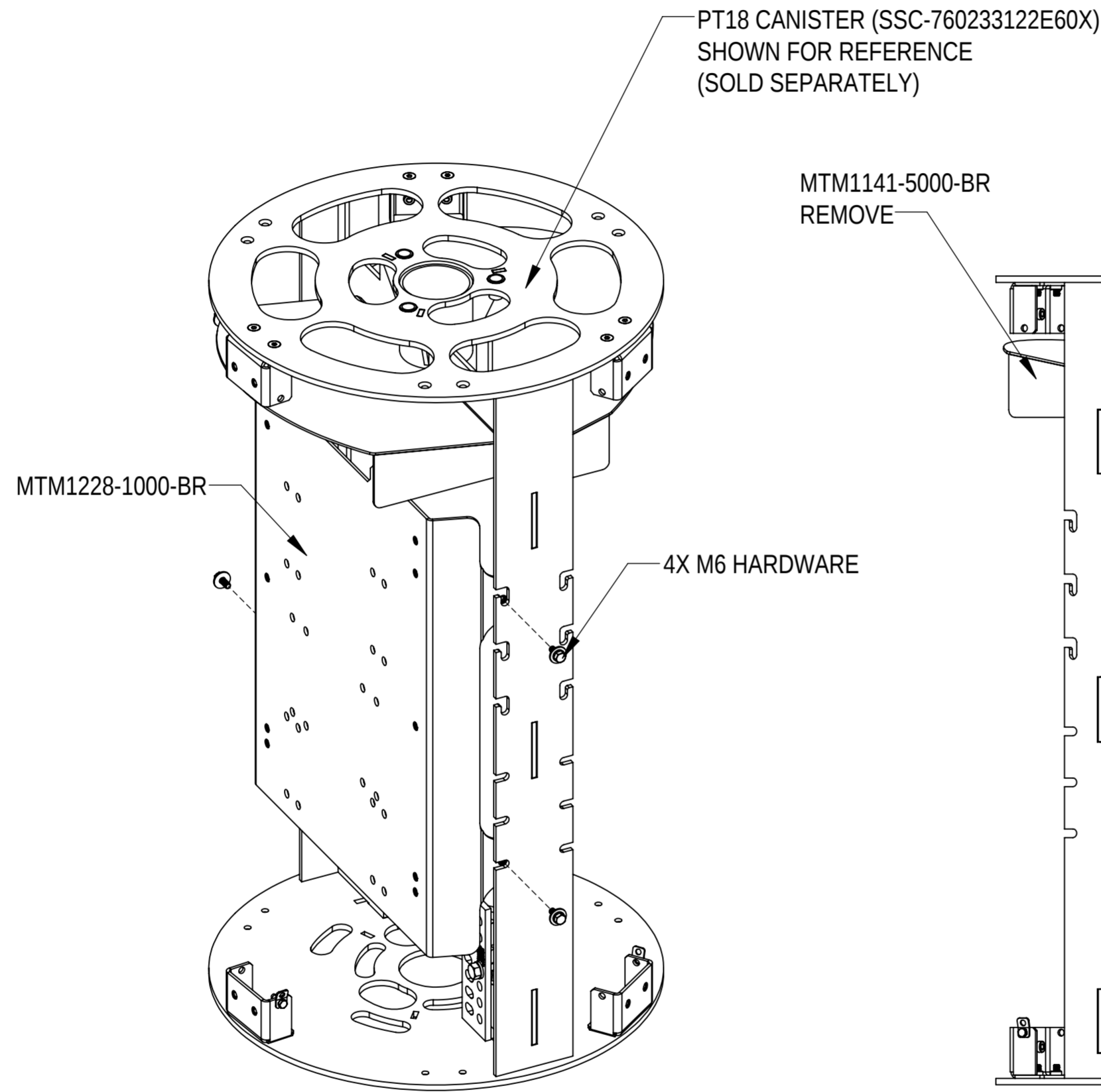

STEP 1(CONFIG 1 & 5)

INSTALL MTM1228-1000-BR TO THE POLETOP USING 4X M6 SCREWS,
 LOCK AND FLAT WASHERS AS SHOWN

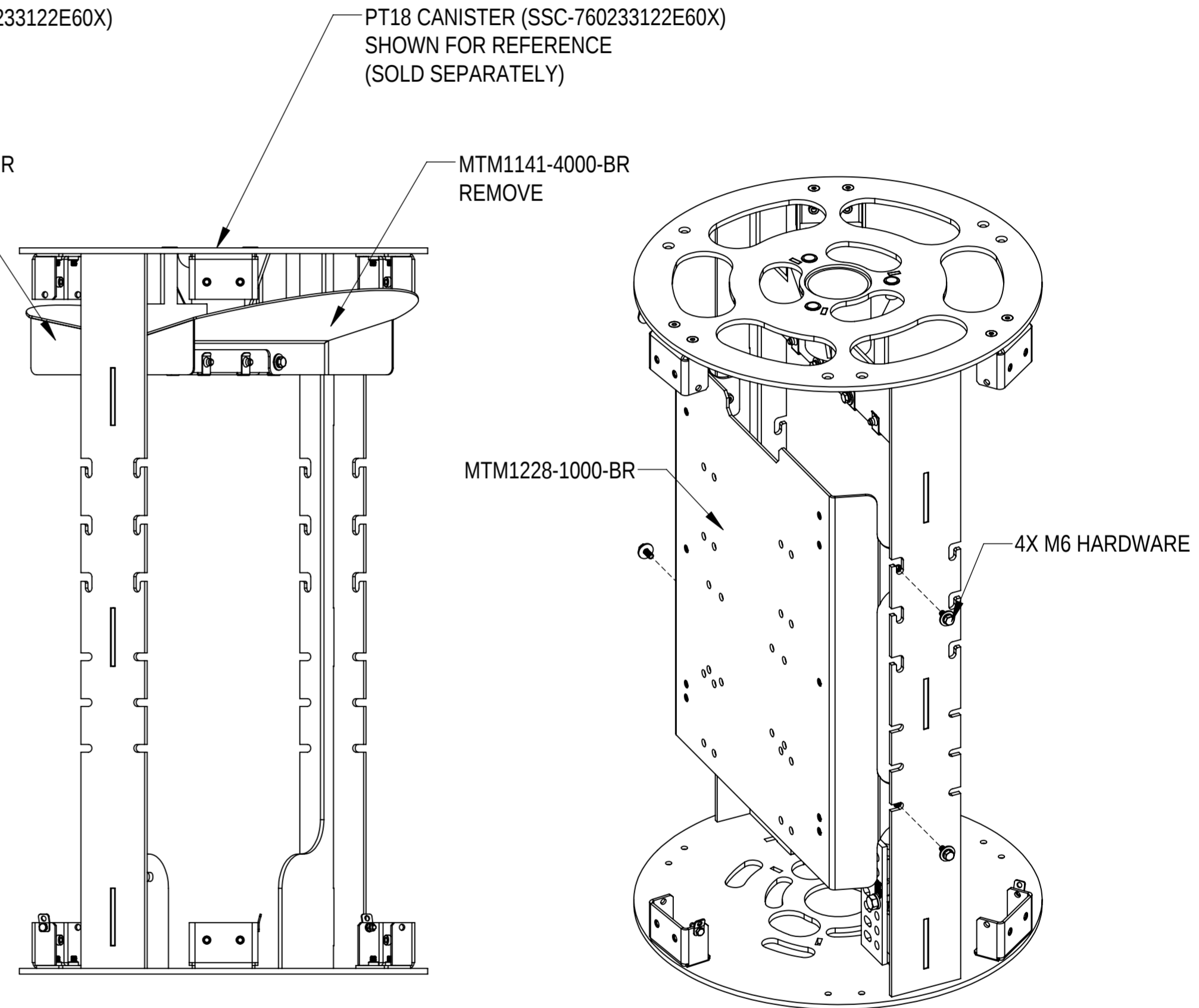

STEP 1(CONFIG 2 & 3 & 4)

- 1) REMOVE BAFFLES MTM1141-4000-BR & MTM1141-5000-BR
- 2) INSTALL MTM1228-1000-BR TO THE POLETOP USING 4X M6 SCREWS,
 LOCK AND FLAT WASHERS AS SHOWN

Installation Instructions



CONFIGURATION 1 - 4438 & 220X OR 440X & 6317

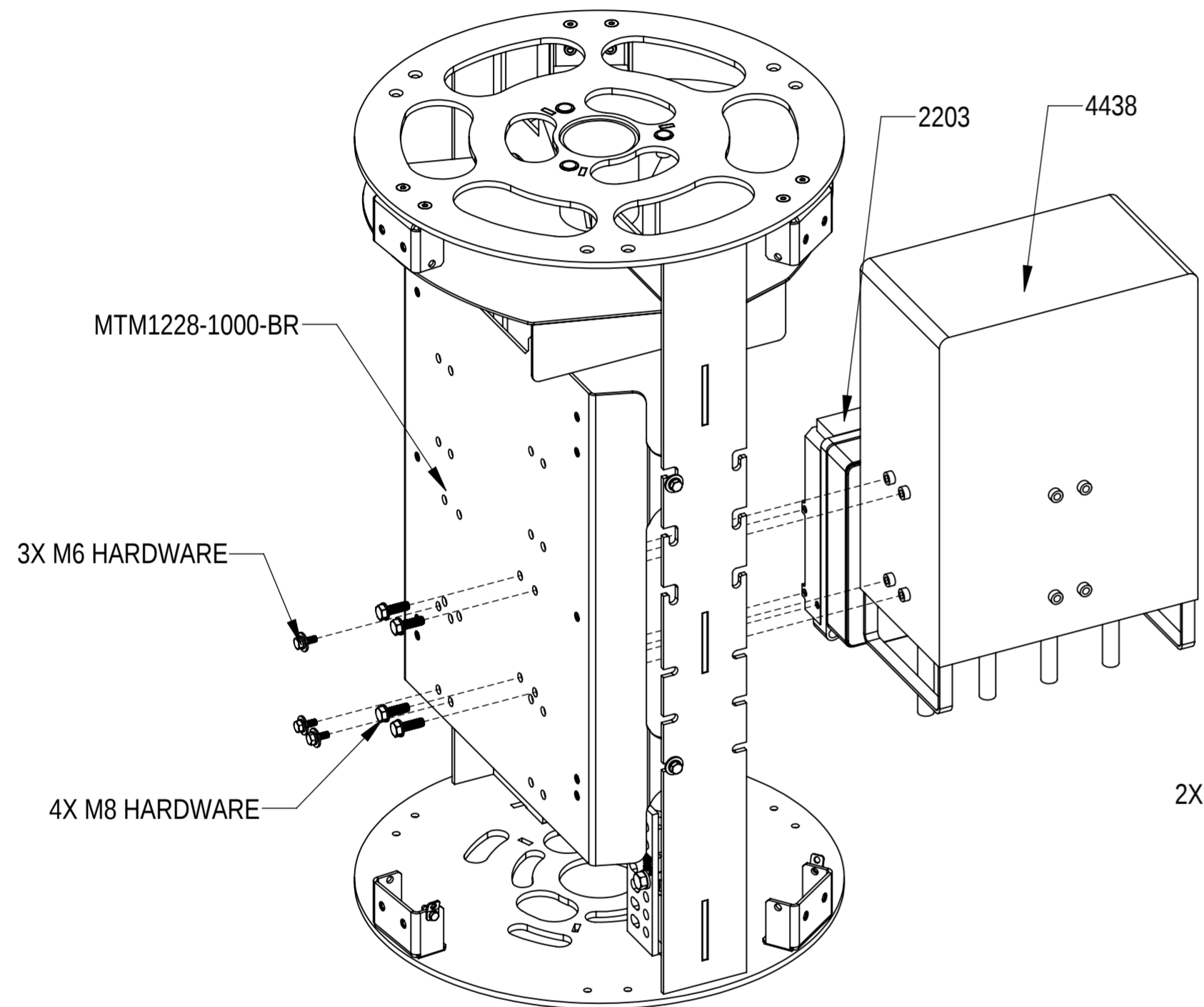

STEP 2

- 1) INSTALL 4438 TO BRACKET MTM1228-1000-BR USING 4X M8 SCREWS AND FLAT WASHERS
- 2) INSTALL 2203 TO BRACKET MTM1228-1000-BR USING 3X M6 SCREWS, LOCK AND FLAT WASHERS

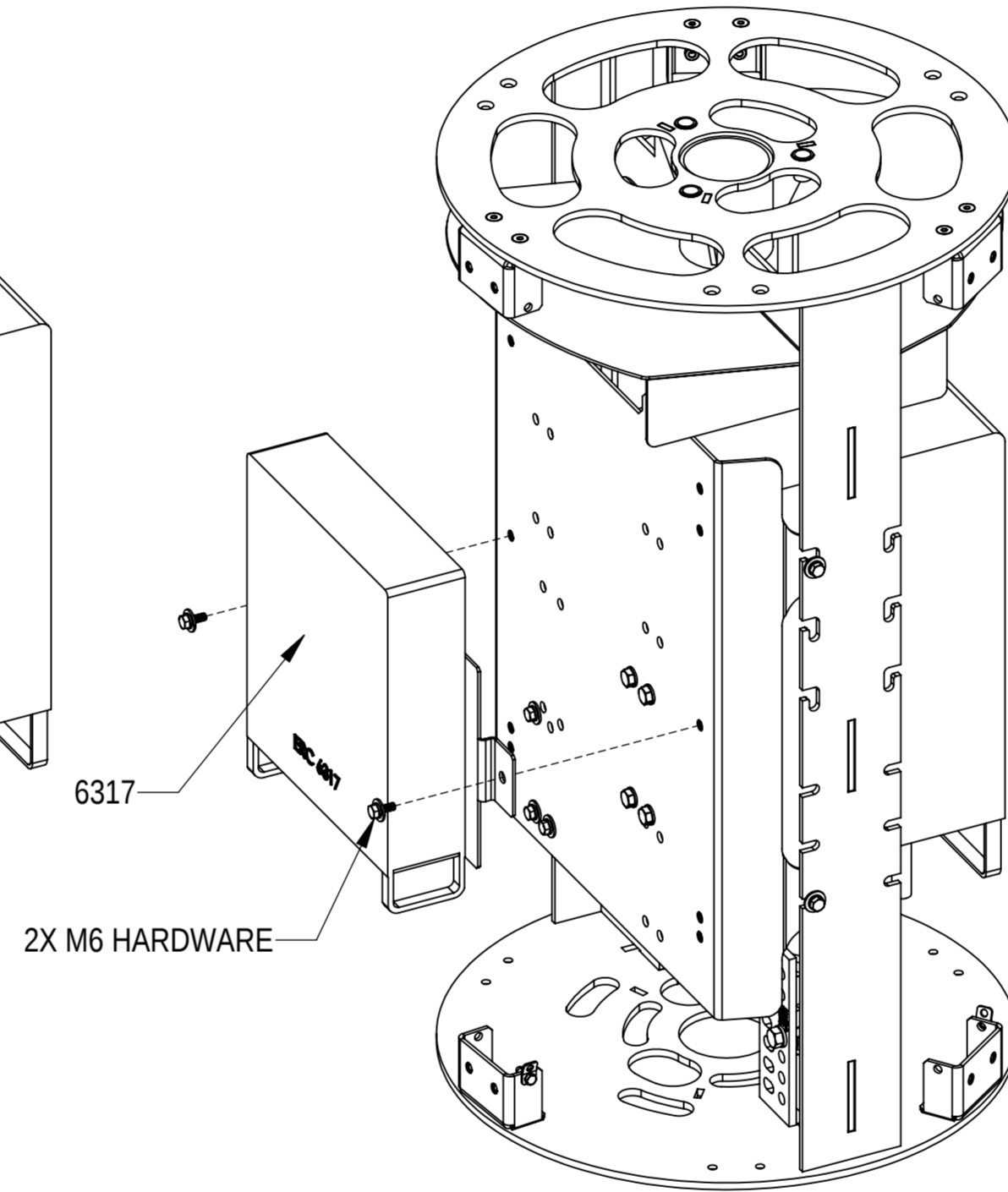

STEP 3

INSTALL 6317 SUB-ASSY TO BRACKET MTM1228-1000-BR USING 2X M6 SCREWS, LOCK AND FLAT WASHERS AS SHOWN

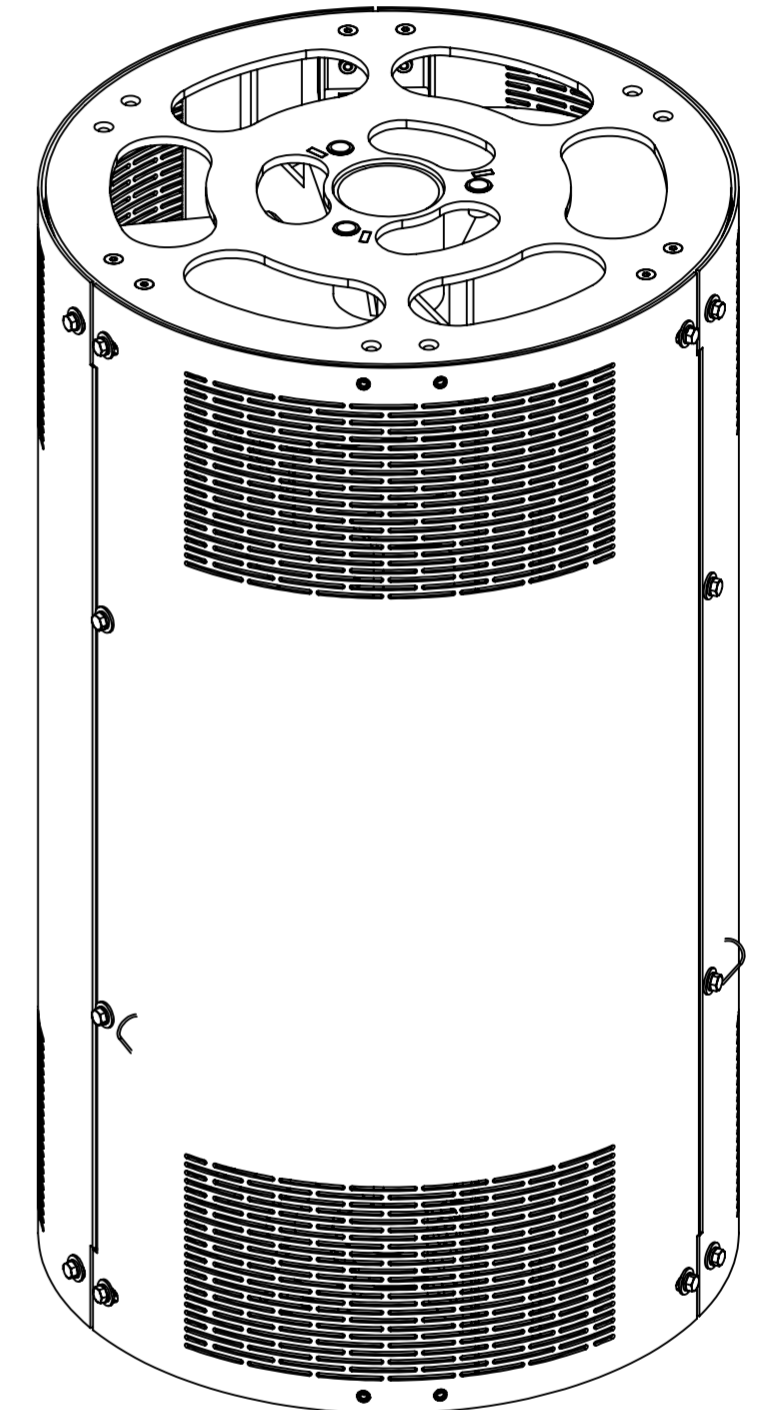

INSTALL THE COVERS TO THE POLETOP USING 18X M6 SCREWS, LOCK AND FLAT WASHERS AS SHOWN

Installation Instructions



CONFIGURATION 2 - 4461 & 2X 220X OR 440X & 6317 & FAN KIT

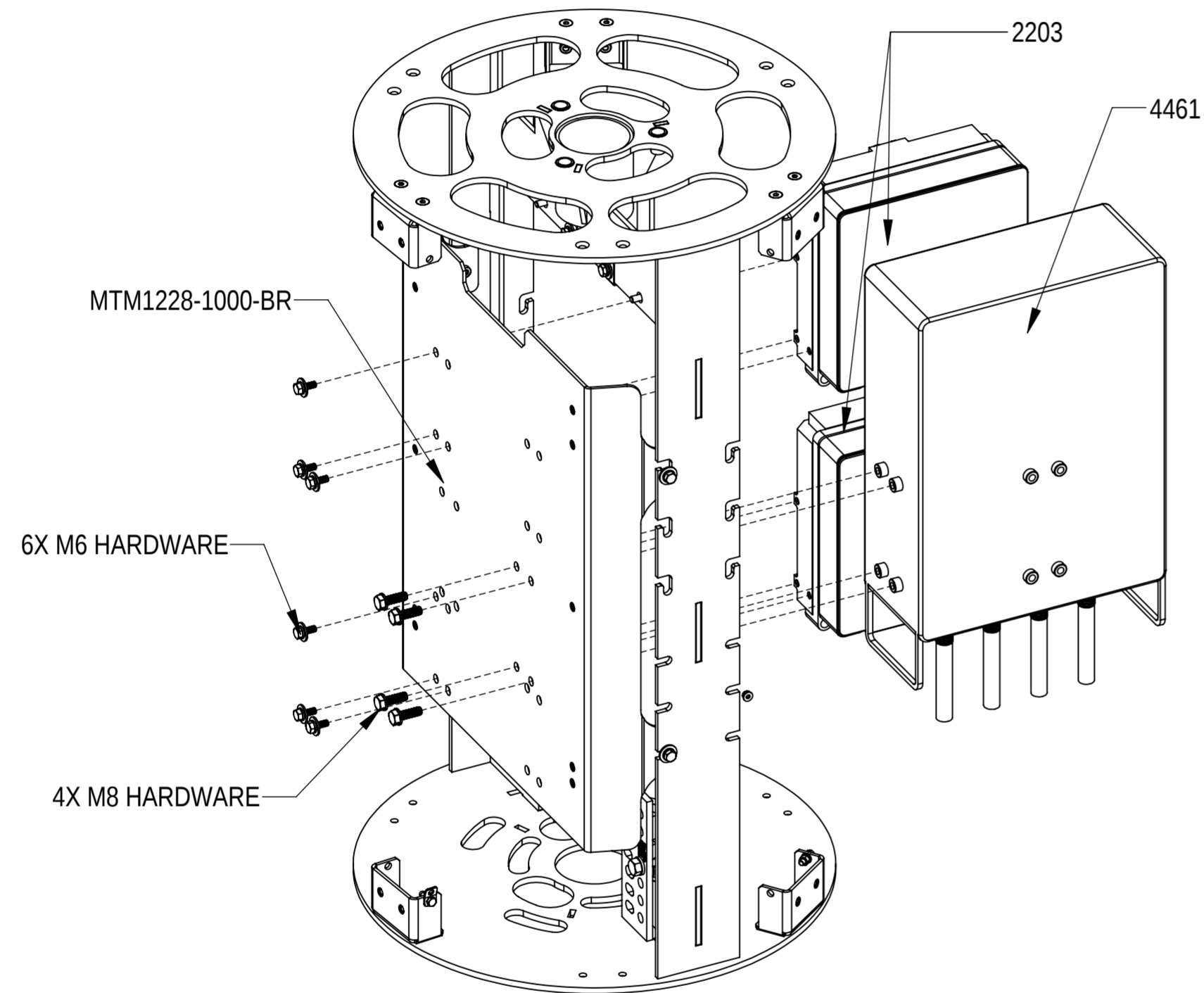

STEP 2

- 1) INSTALL 4461 TO BRACKET MTM1228-1000-BR USING 4X M8 SCREWS AND FLAT WASHERS
- 2) INSTALL 2X 2203 TO BRACKET MTM1228-1000-BR USING 6X M6 SCREWS, LOCK AND FLAT WASHERS

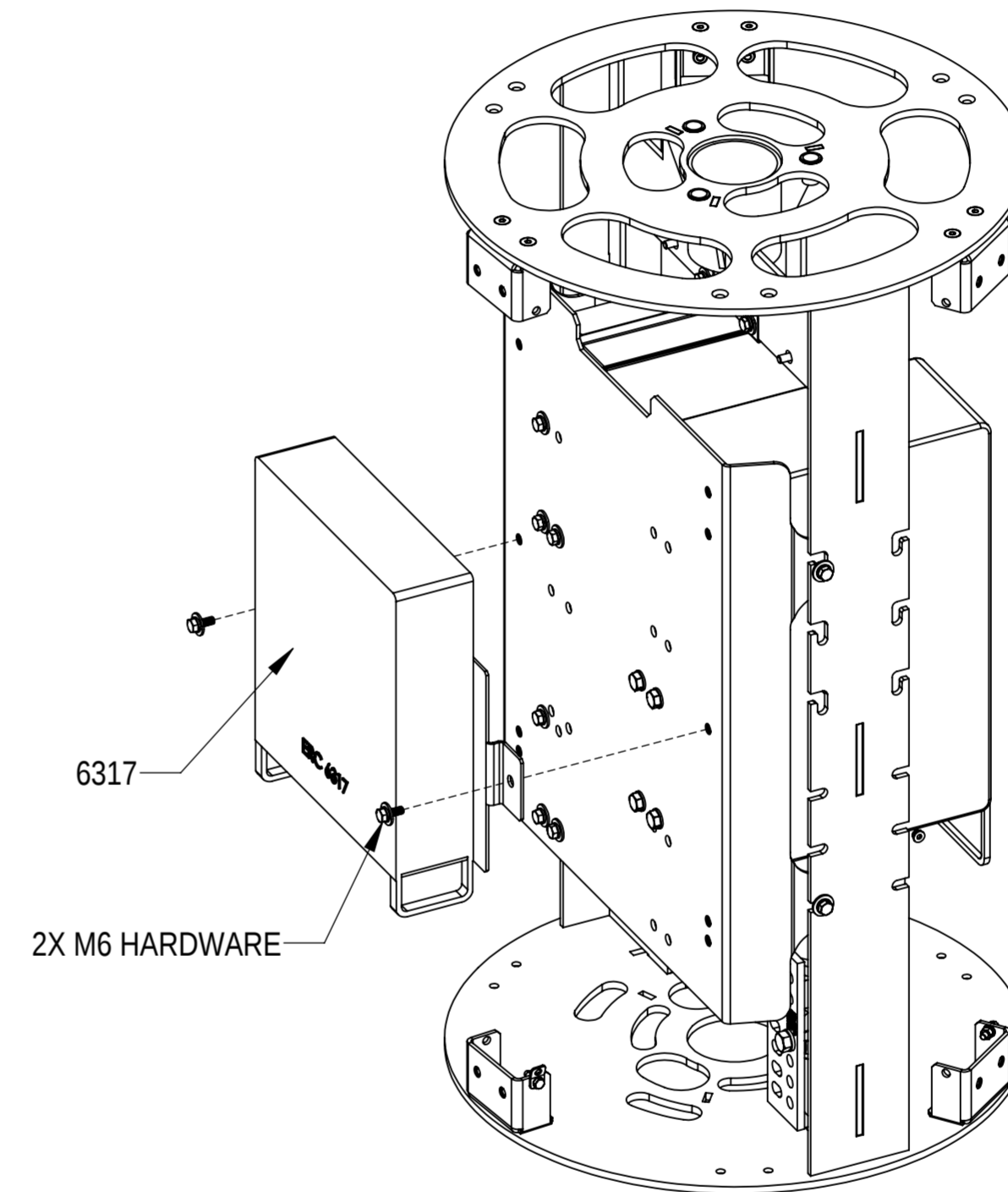

STEP 3

INSTALL 6317 SUB-ASSY TO BRACKET MTM1228-1000-BR USING 2X M6 SCREWS, LOCK AND FLAT WASHERS AS SHOWN

Installation Instructions

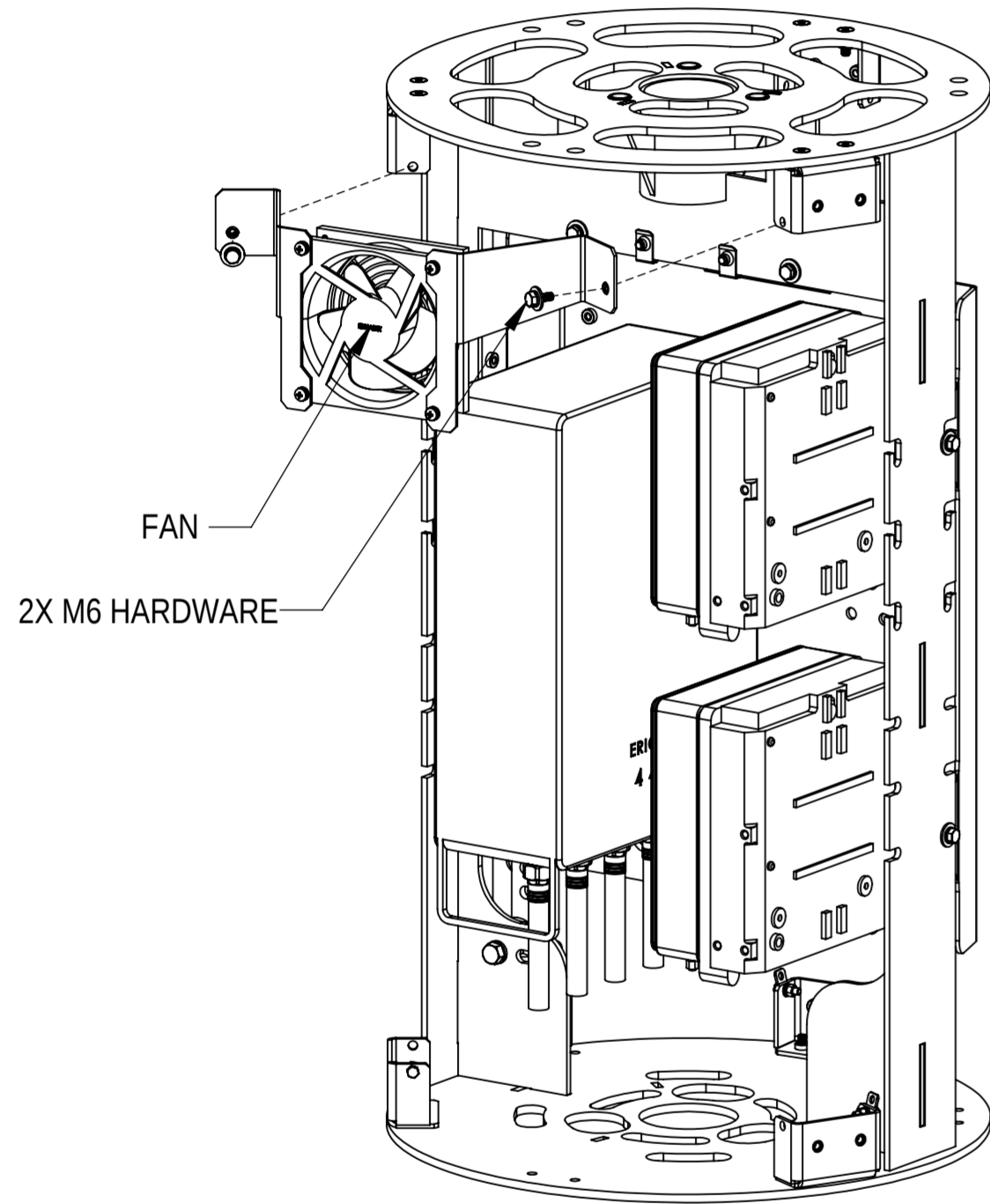

STEP 4

INSTALL FAN ASSY TO THE POLETOP USING 2 SETS OF M6 SCREWS, LOCK & FLAT WASHERS AS SHOWN

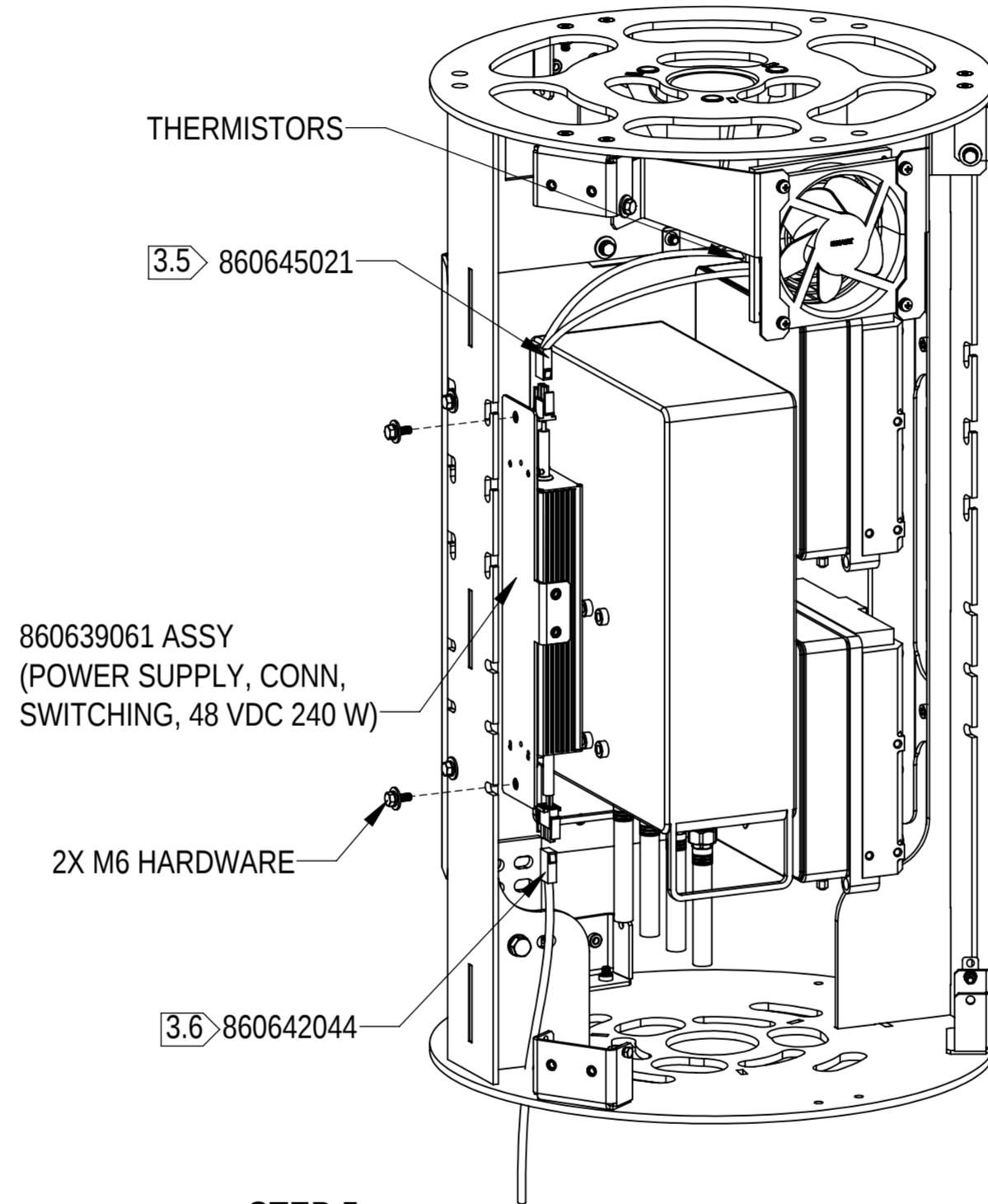

STEP 5

1) INSTALL Y-CABLE 860645021 & POWER CABLE 860642044 TO POWER 860639061 ASSY

2) INSTALL 860639061 ASSY TO THE POLETOP USING 2 SETS OF M6 SCREWS, LOCK & FLAT WASHERS AS SHOWN

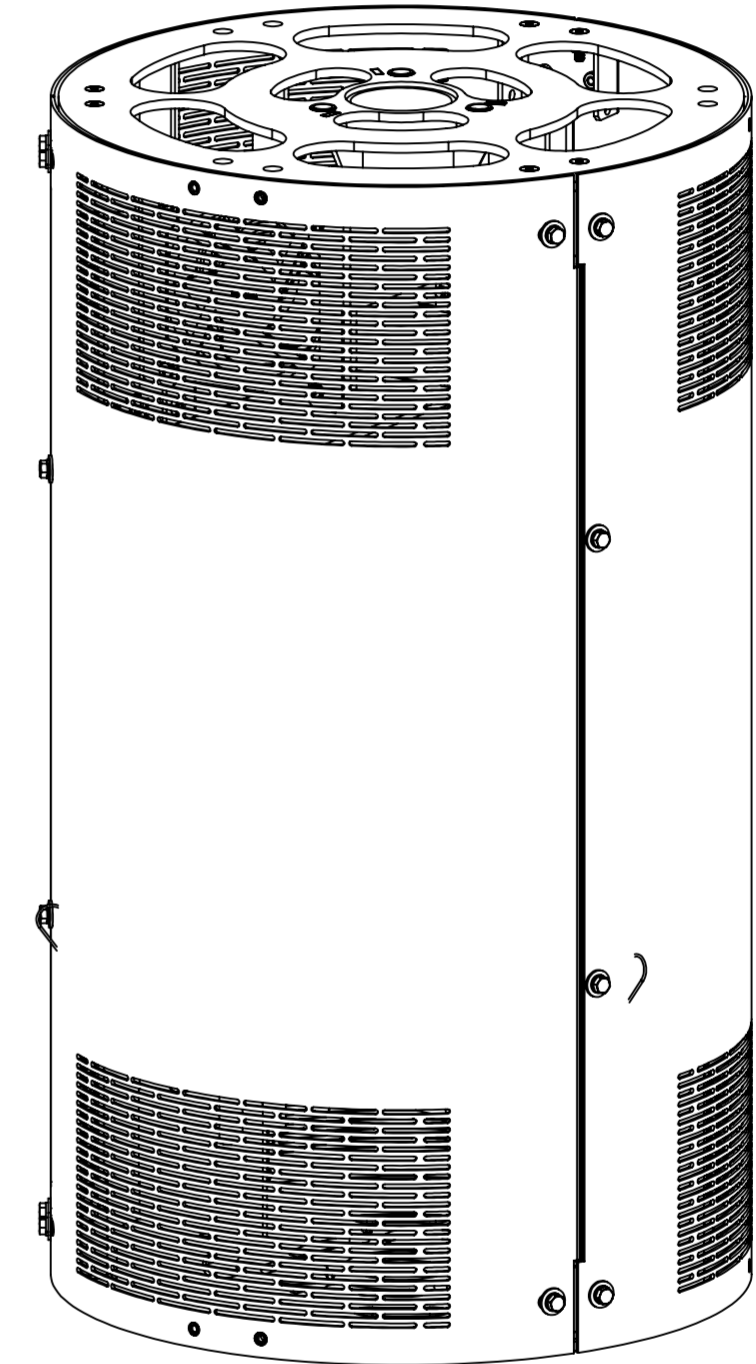

INSTALL THE COVERS TO THE POLETOP USING 18X M6 SCREWS, LOCK AND FLAT WASHERS AS SHOWN

Installation Instructions



CONFIGURATION 3 - 4438 & 4461 & 2X 6317 & FAN KIT

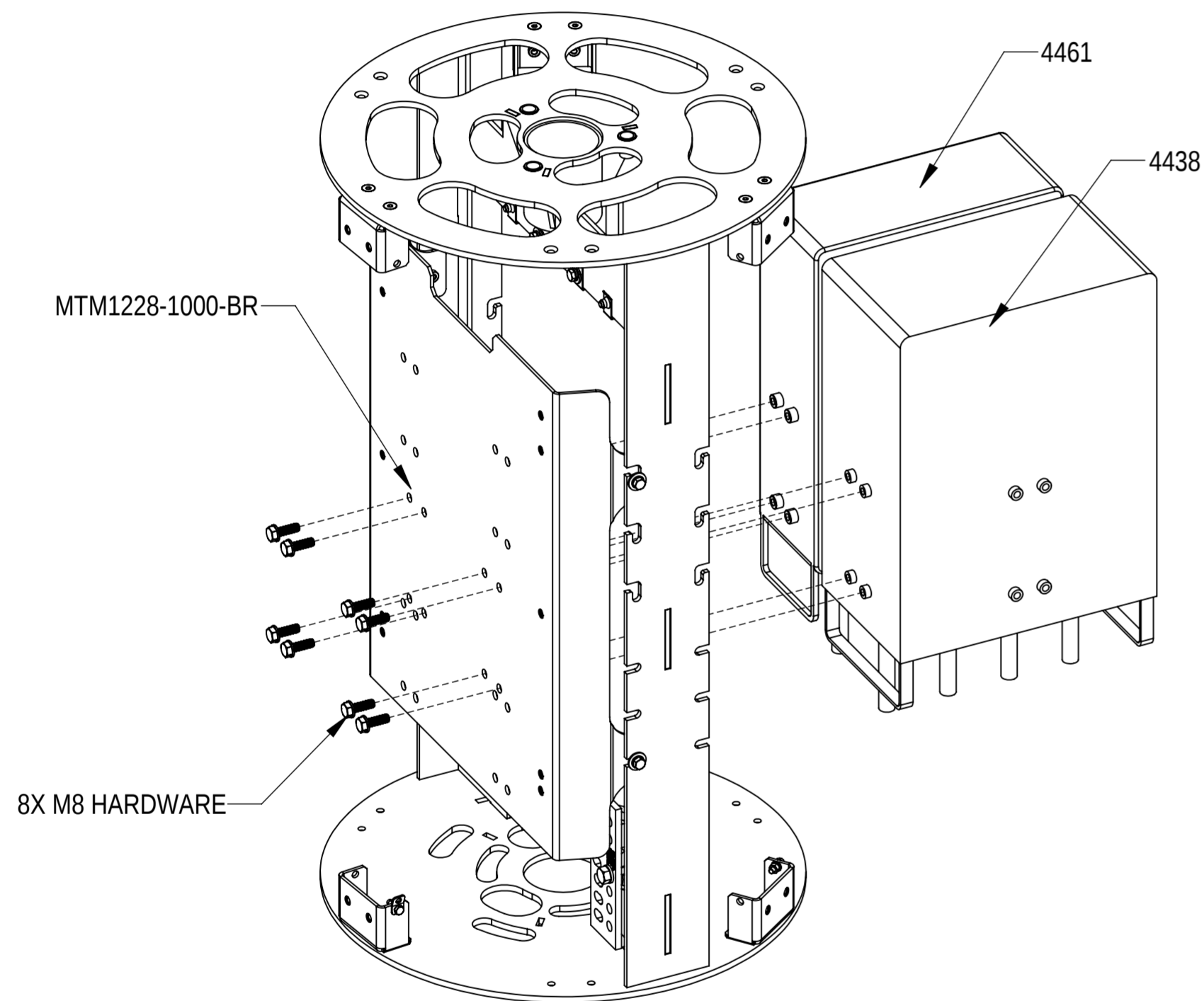

STEP 2

- 1) INSTALL 4438 TO BRACKET MTM1228-1000-BR USING 4X M8 SCREWS AND FLAT WASHERS
- 2) INSTALL 4461 TO BRACKET MTM1228-1000-BR USING 4X M8 SCREWS AND FLAT WASHERS

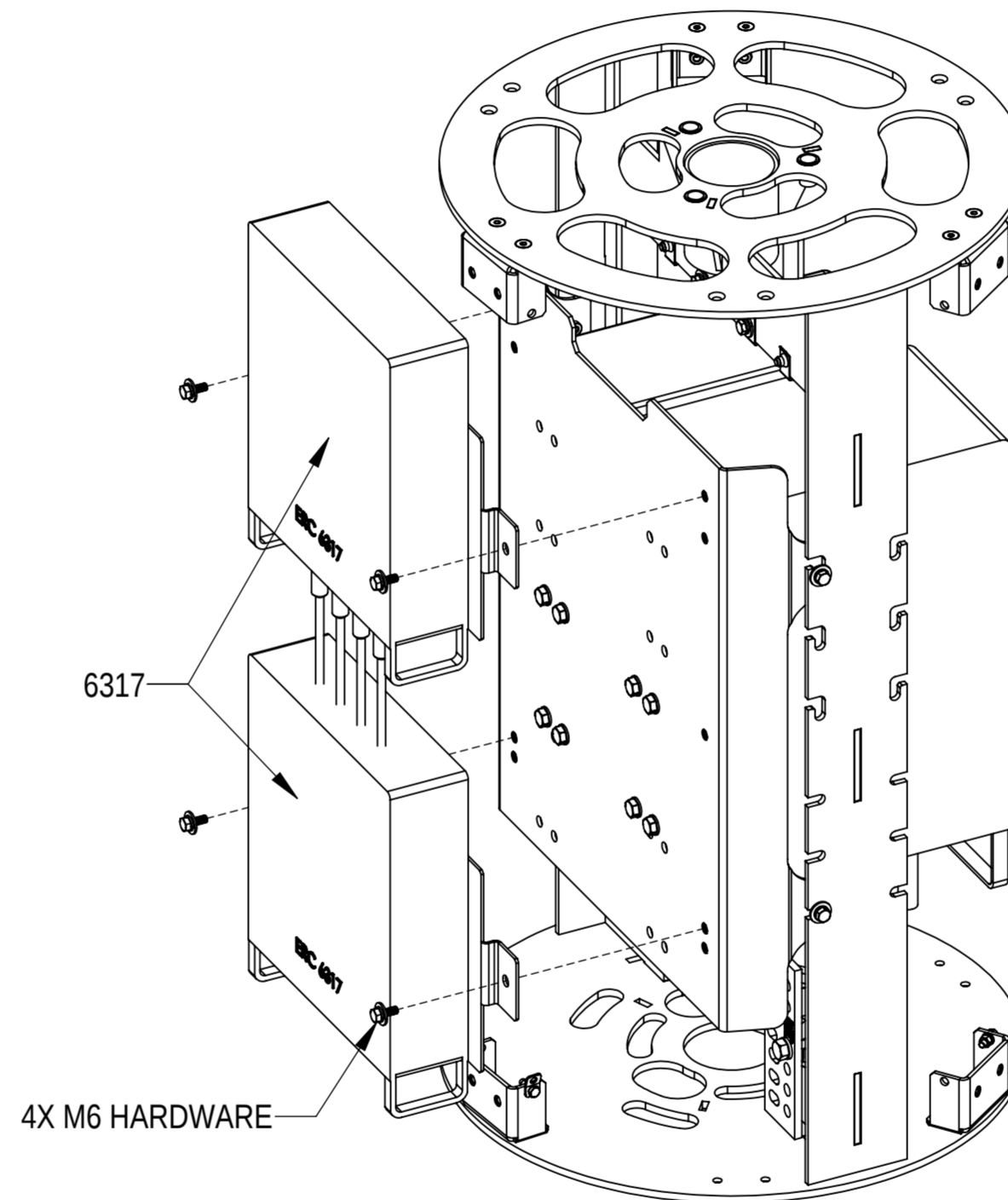

STEP 3

INSTALL 2X 6317 SUB-ASSY TO BRACKET MTM1228-1000-BR USING 4X M6 SCREWS, LOCK AND FLAT WASHERS AS SHOWN

IF THERE IS INTERFERENCE BETWEEN PSU-6317 AND THE TAB, MOVE THE PSU-6317 DOWNWARDS AS SHOWN IN THE SECOND PICTURE OF STEP 3.

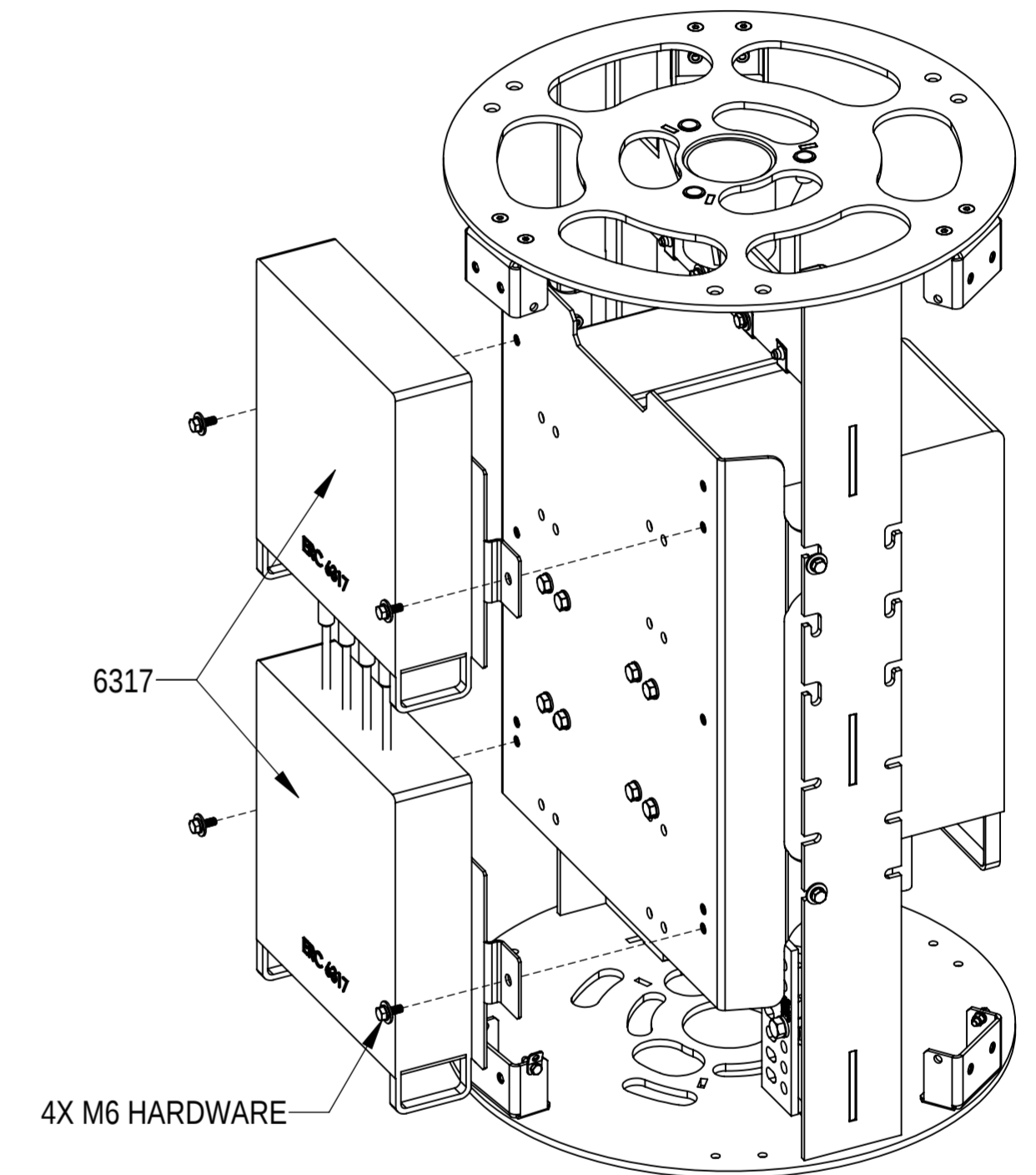

Installation Instructions

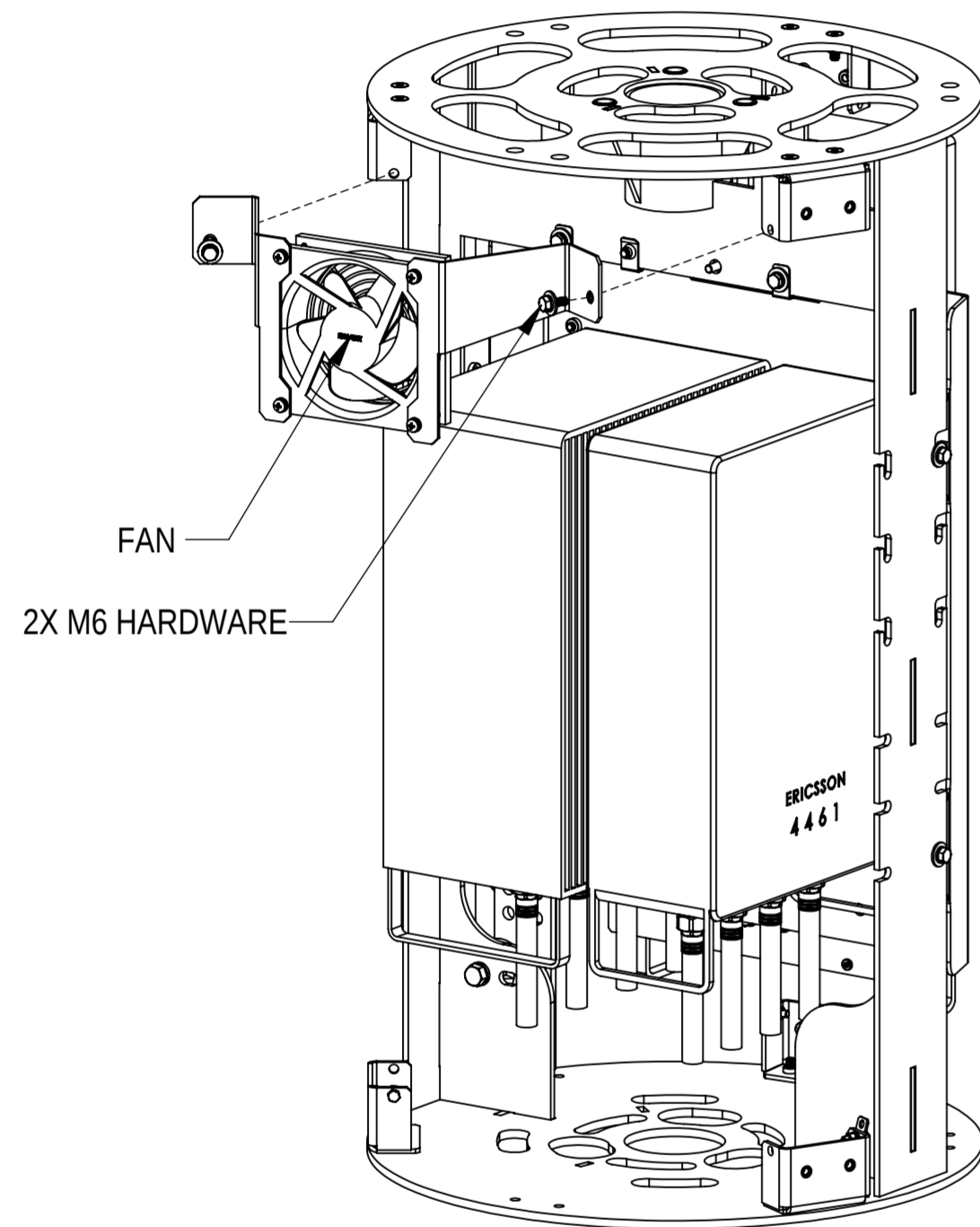

STEP 4

INSTALL FAN ASSY TO THE POLETOP USING 2 SETS OF M6 SCREWS, LOCK & FLAT WASHERS AS SHOWN

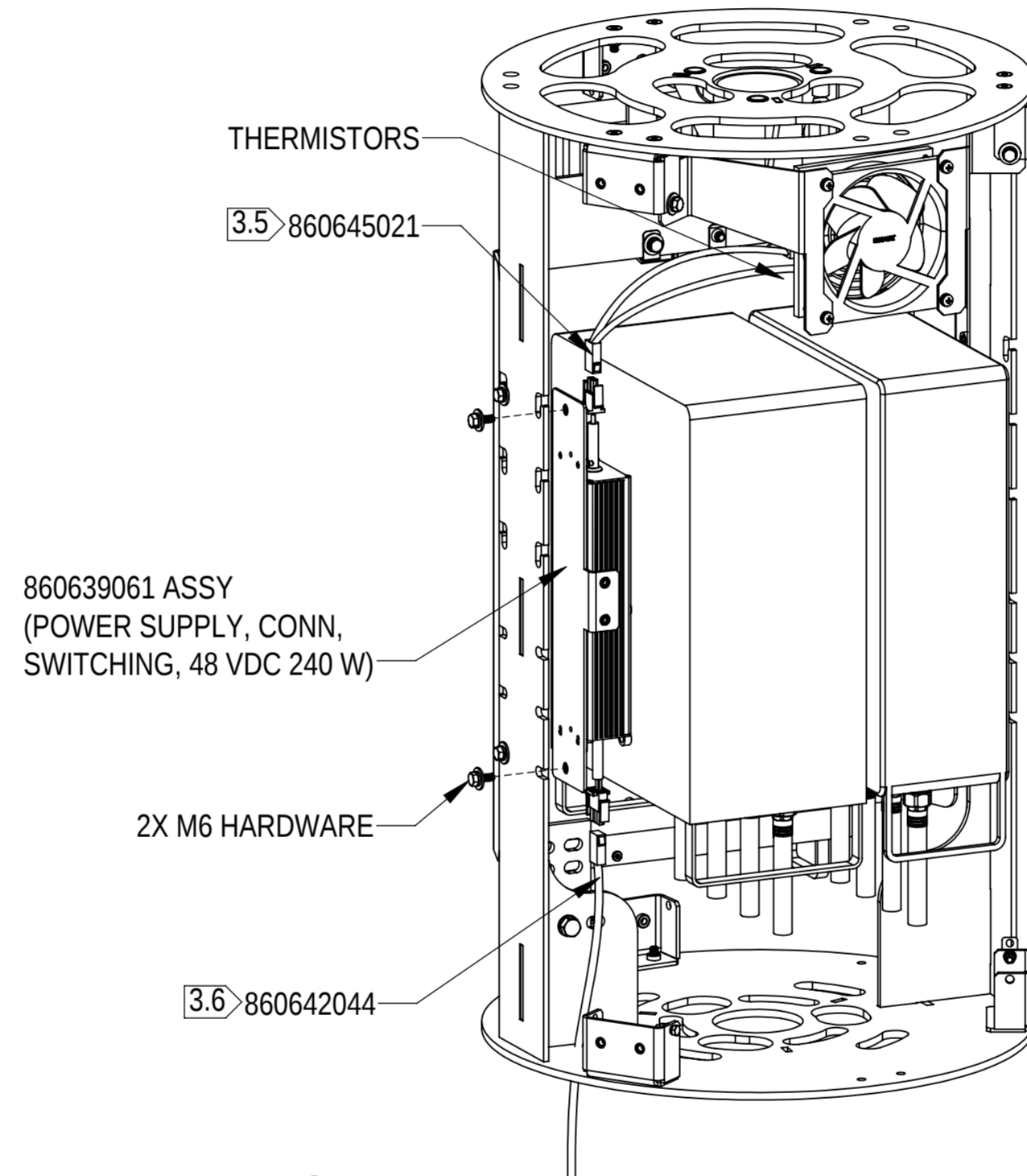

STEP 5

INSTALL Y-CABLE 860645021 & POWER CABLE 860642044 TO POWER 860639061 ASSY

INSTALL 860639061 ASSY TO THE POLETOP USING 2 SETS OF M6 SCREWS, NUTS AS SHOWN

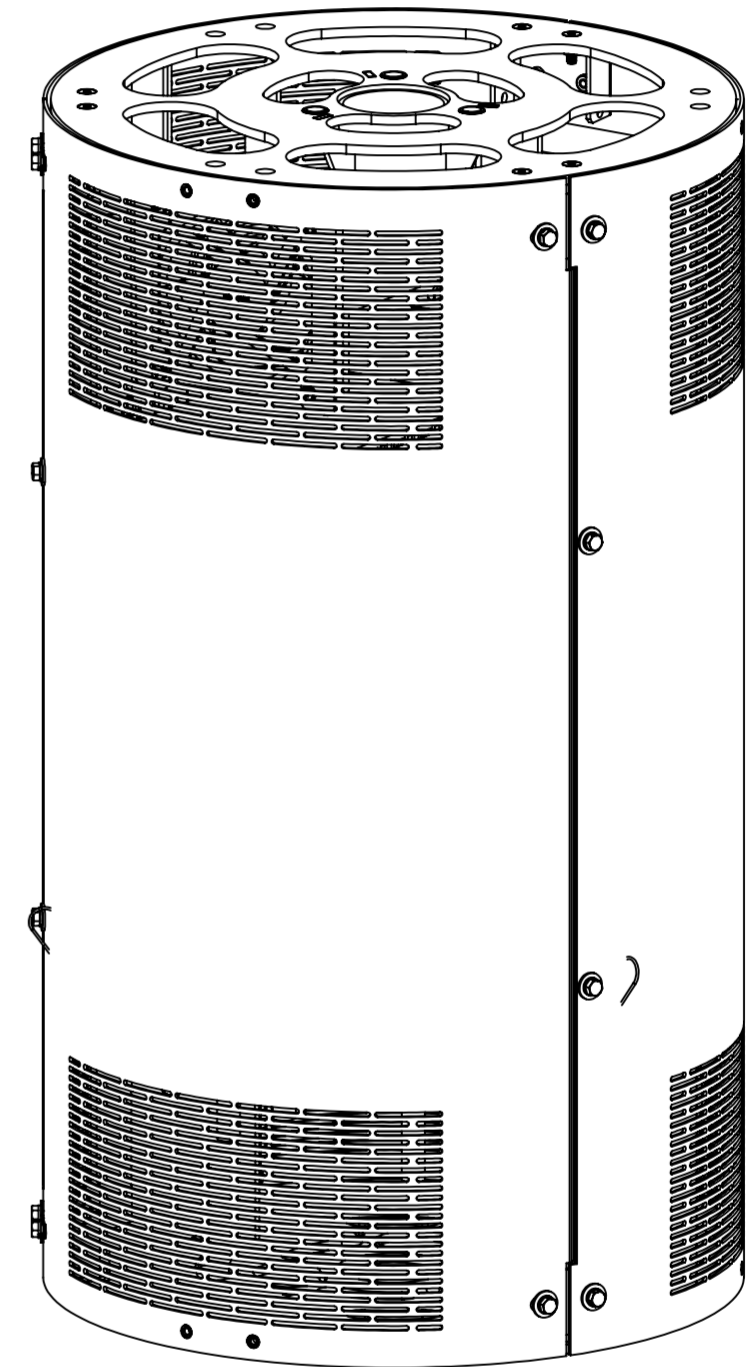

INSTALL THE COVERS TO THE POLETOP USING 18X M6 SCREWS, LOCK AND FLAT WASHERS AS SHOWN

CONFIGURATION 4 - 4461 & 4471 & 2X AC08 & FAN KIT

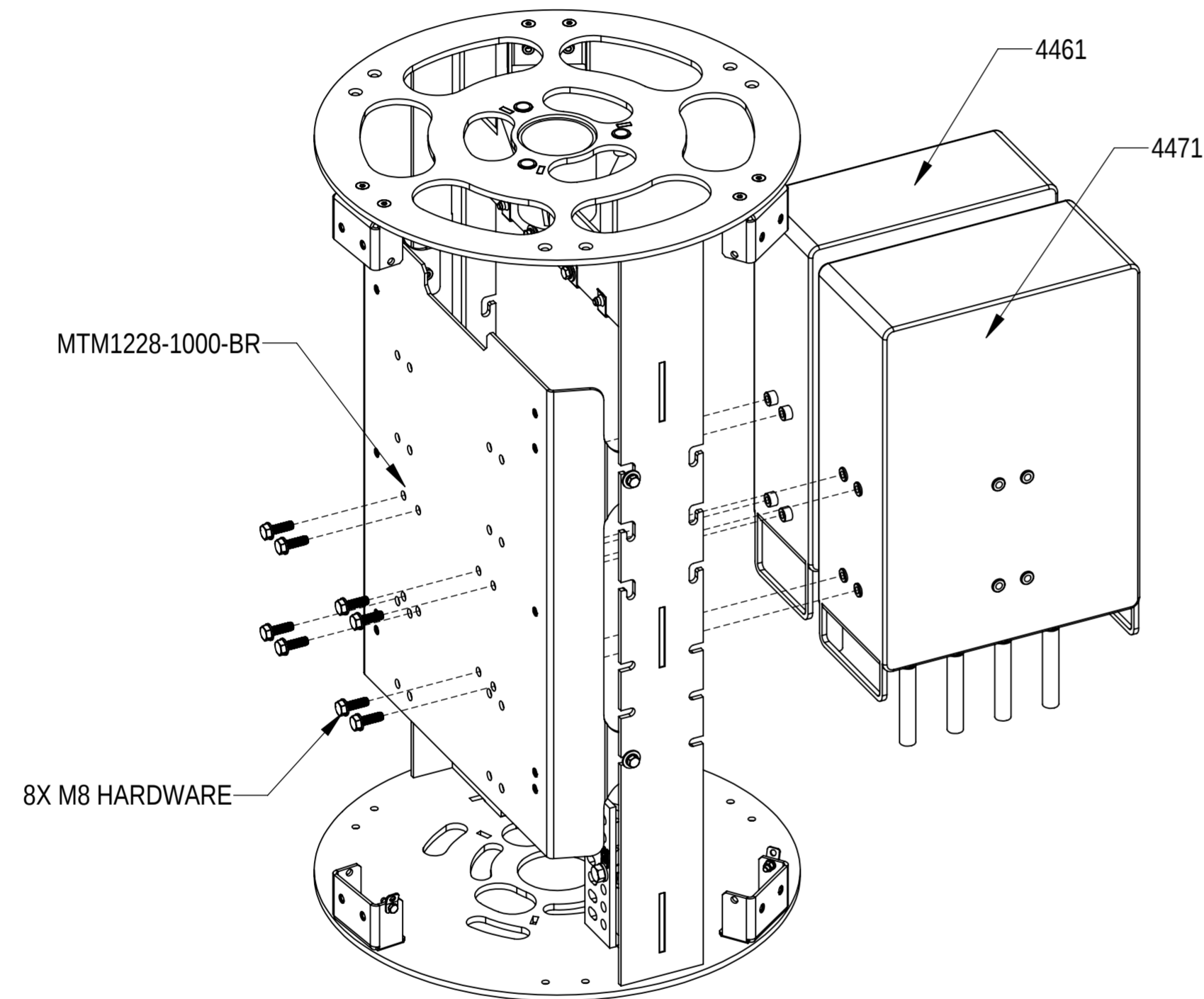

STEP 2

- 1) INSTALL 4461 TO BRACKET MTM1228-1000-BR USING 4X M8 SCREWS AND FLAT WASHERS
- 2) INSTALL 4471 TO BRACKET MTM1228-1000-BR USING 4X M8 SCREWS AND FLAT WASHERS

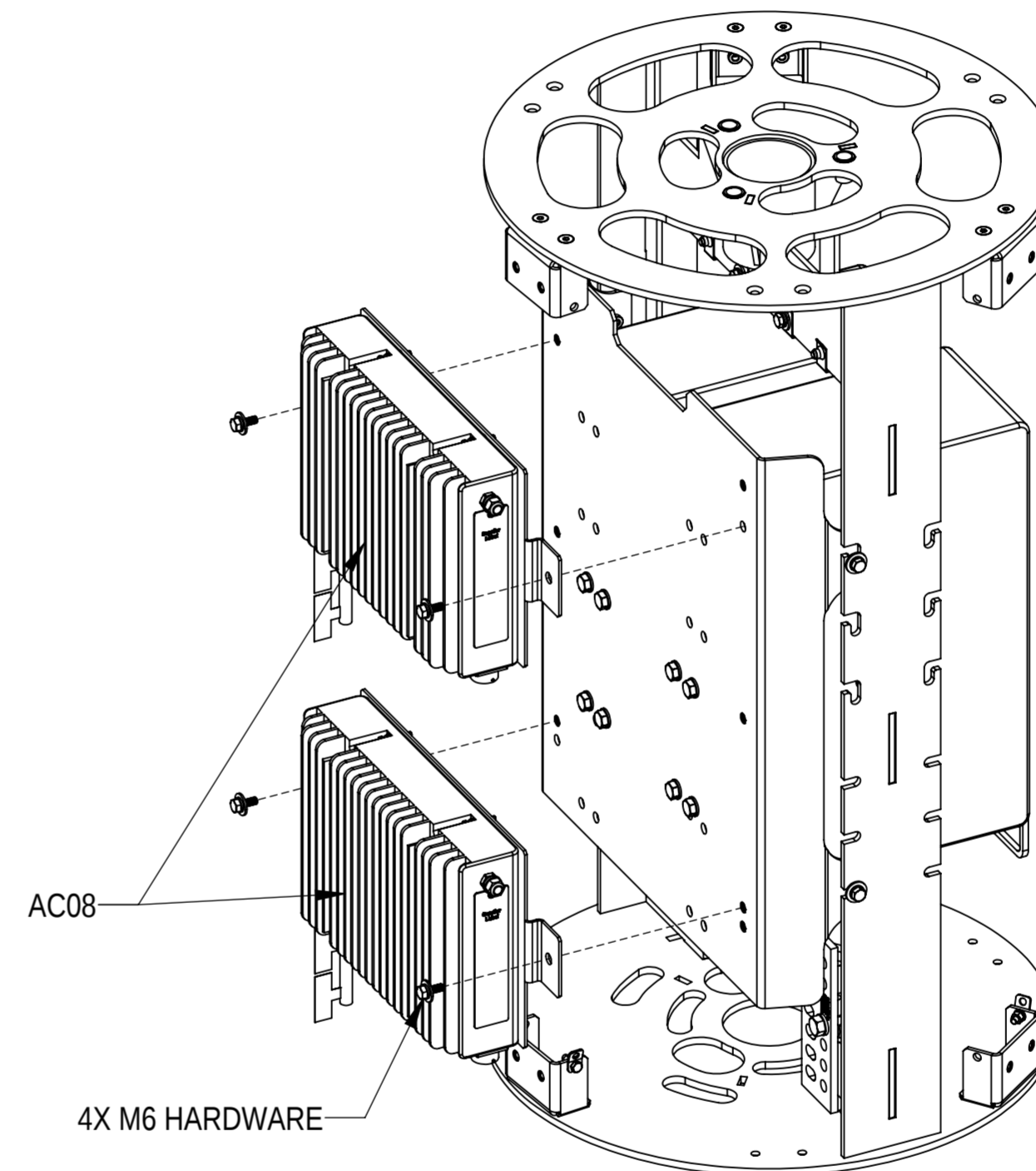

STEP 3

INSTALL 2X AC08 SUB-ASSY TO BRACKET MTM1228-1000-BR USING 4X M6 SCREWS, LOCK AND FLAT WASHERS AS SHOWN

Installation Instructions

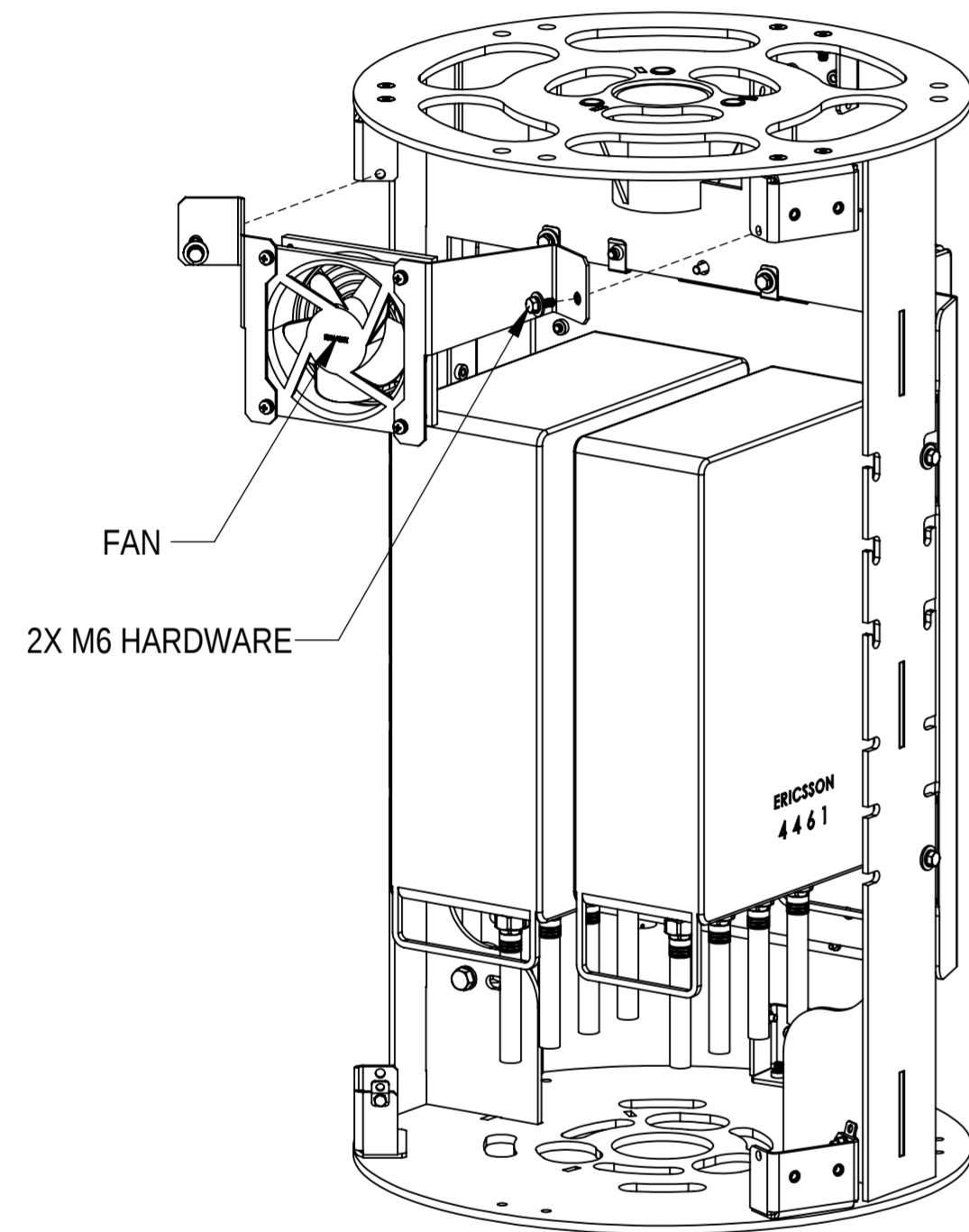

STEP 4

INSTALL FAN ASSY TO THE POLETOP USING 2 SETS OF M6 SCREWS, LOCK & FLAT WASHERS AS SHOWN

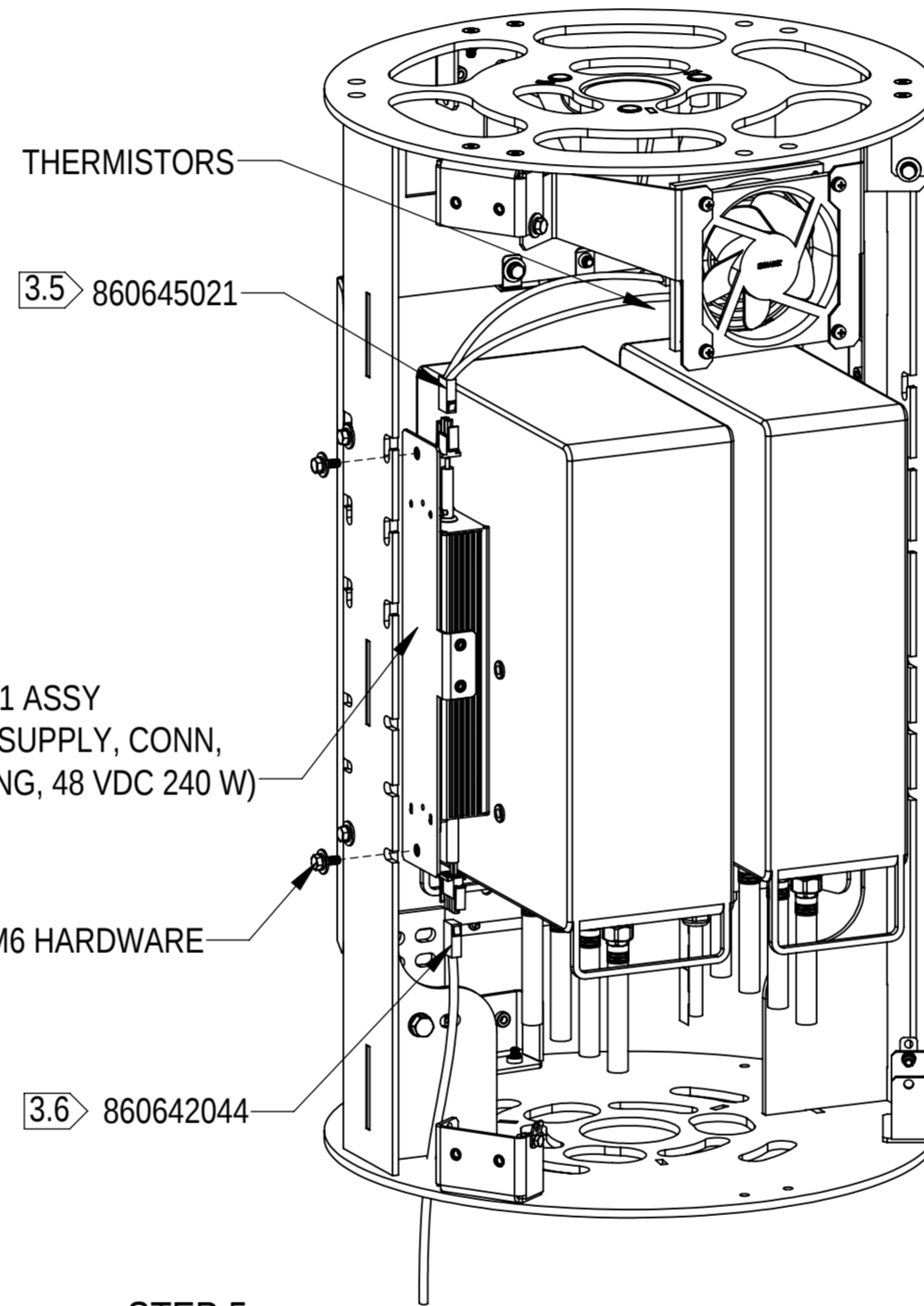

STEP 5

INSTALL Y-CABLE 860645021 & POWER CABLE 860642044 TO POWER 860639061 ASSY

INSTALL 860639061 ASSY TO THE POLETOP USING 2 SETS OF M6 SCREWS, NUTS AS SHOWN

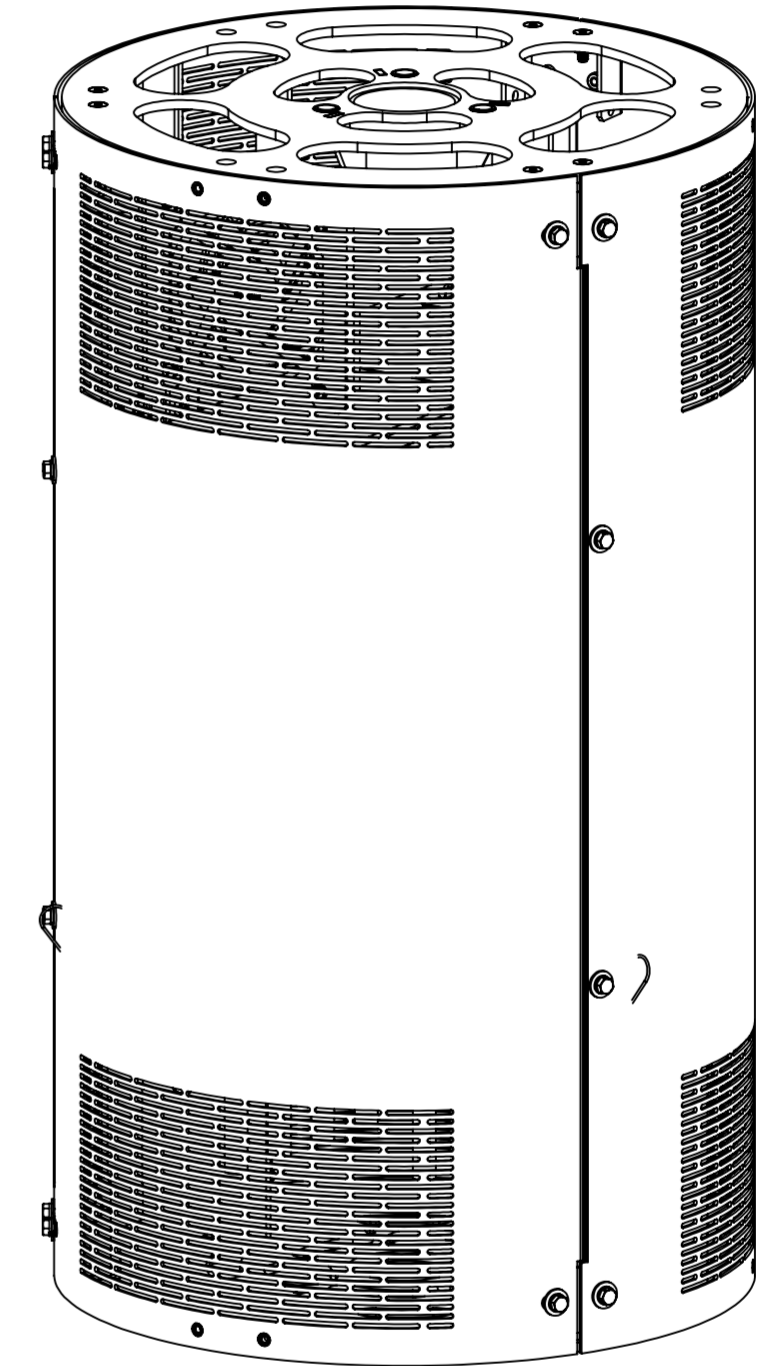

INSTALL THE COVERS TO THE POLETOP USING 18X M6 SCREWS, LOCK AND FLAT WASHERS AS SHOWN

Installation Instructions



CONFIGURATION 5 - 4X 440X & 2X AC08

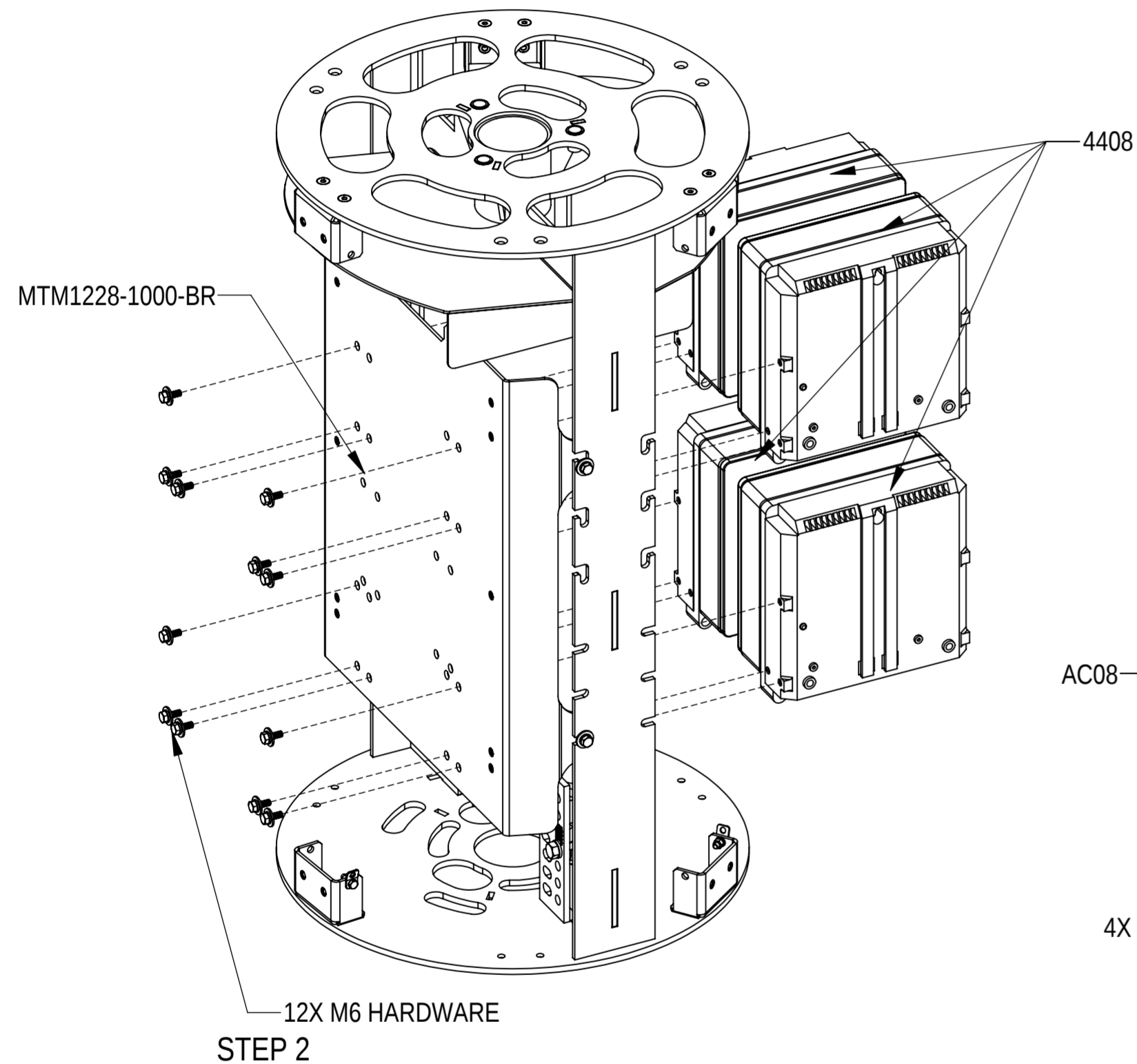

INSTALL 4X 4408 TO BRACKET MTM1228-1000-BR
USING 12X M6 SCREWS AND FLAT WASHERS

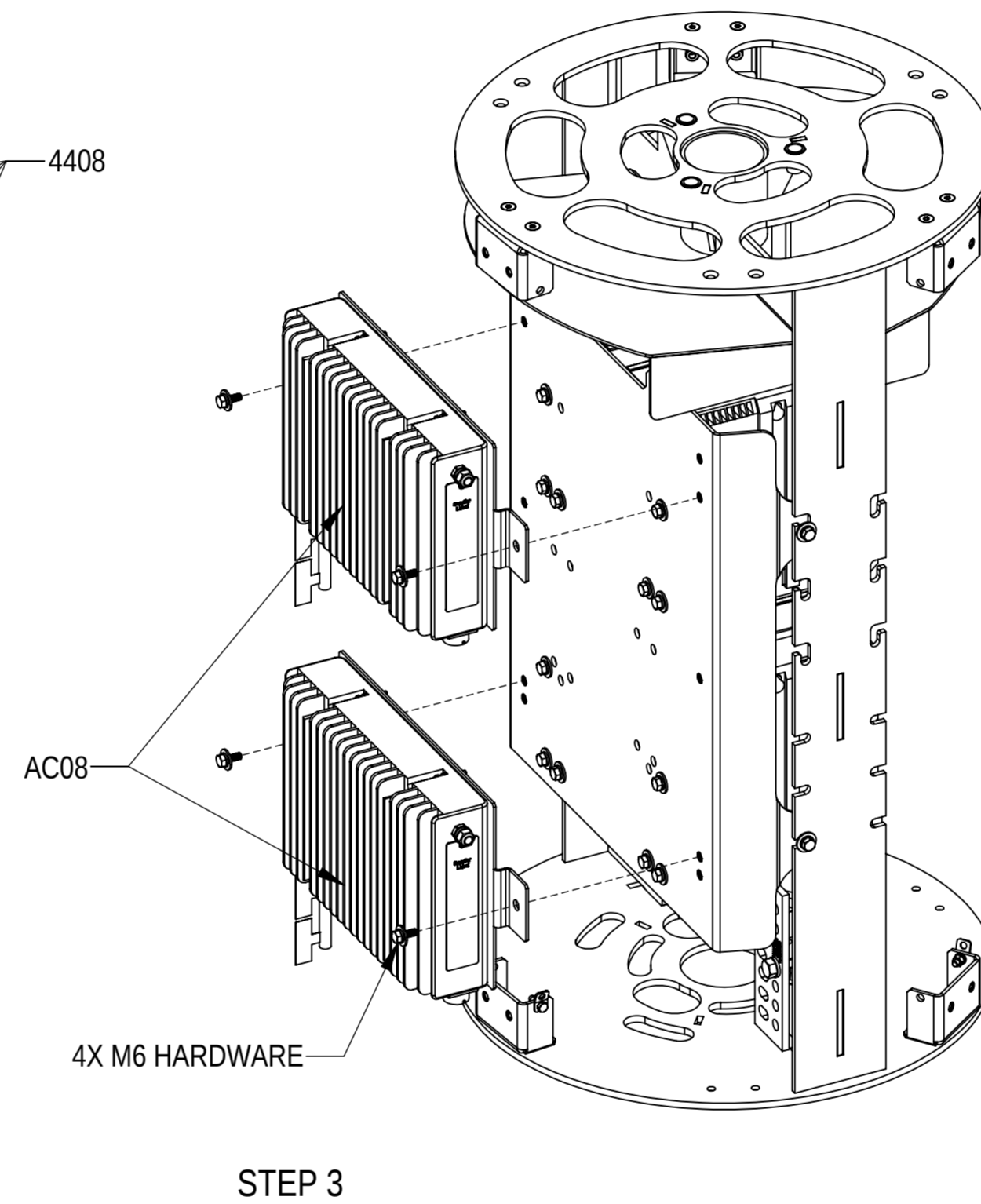

INSTALL 2X AC08 SUB-ASSY TO BRACKET MTM1228-1000-BR
USING 4X M6 SCREWS, LOCK AND FLAT WASHERS AS
SHOWN

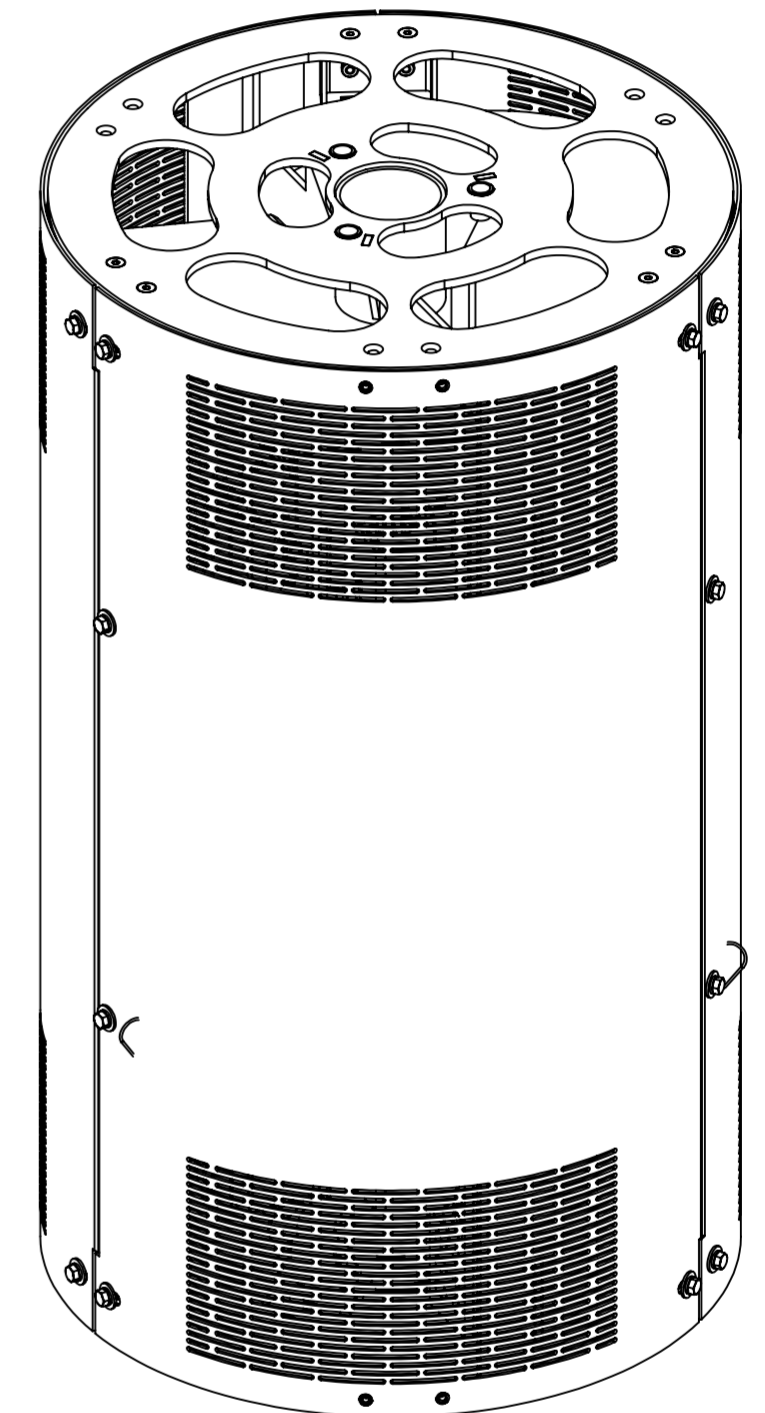

INSTALL THE COVERS TO THE POLETOP USING 18X M6
SCREWS, LOCK AND FLAT WASHERS AS SHOWN